

Cell Phone Lockers

continued on pages 88 - 89

CELL PHONE LOCKERS

Made entirely of aluminum, Salsbury 19100 series cell phone lockers with front access panels are ideal for use in health clubs, government facilities, office buildings, schools and other settings where small personal items need to be stored safely and securely. Cell phone lockers can be surface mounted or recessed mounted and accommodate cell phones, tablet PC's, wallets, cameras, keys and other small valuable items. Cell phone lockers feature a durable powder coated finish available in three (3) contemporary colors and six (6) door configurations with standard A doors (6-1/2" W x 5-1/4" H) and larger B doors (13" W x 5-1/4" H). Cell phone locker compartments are 8" deep and feature master keyed locks or resettable combination locks. Master keyed locks include three (3) keys and allow access to all compartments with a master control key (#19991). Resettable combination locks can be set to a fixed combination or a combination that can be reset after each use. Each cell phone locker door includes a 2" W x 5/8" H clear plastic cardholder (card included) to identify the compartment. Custom engraved placards (#19967) and custom door engraving (#19968 - regular and #19962 - black filled) are available as options upon request. See cell phone locker options and locks on page 89.

CELL PHONE LOCKER SAMPLE INSTALLATIONS

SURFACE MOUNTED

Model displayed:
(1) 19158-25

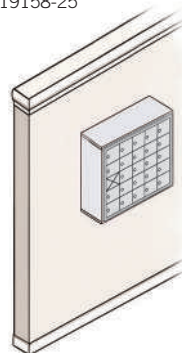

19158-25

Surface mounted units mount directly to a flat surface and are secured with mounting hardware (not included) through the back panel.

RECESSED MOUNTED

Model displayed:
(1) 19158-25

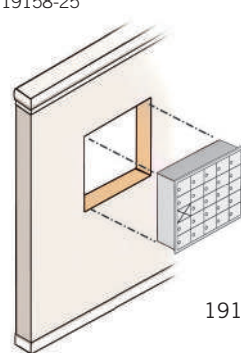

19158-25

Recessed mounted units fit into a rough opening and are secured with mounting hardware (not included) through the back or side panels. Recessed mounted units feature a fully integrated flanged collar which fits over the rough opening.

Additional Units and Volume Discount Pricing Available at Mailboxes.com!

Note: The rough opening for recessed mounted cell phone lockers is 2-1/4" less than the surface mounted unit's width, 2-1/4" less than the unit's height and equal to the unit's depth.



#19158-25's - surface mounted units with resettable combination locks displayed

Ideal for:

- Health Clubs
- Military Bases
- Office Buildings
- Schools and Universities
- Employee Breakrooms
- High Security Locations
- Government Facilities



CUSTOM CELL PHONE LOCKERS

see pages 88-89

- Larger Door Sizes Available
- Custom Configurations
- Alternate Locking Systems
- Multiple Depths Available

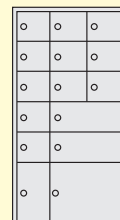

DESCRIPTION

19158-09^{1,2,3}**Cell Phone Locker**

8 "A" Doors (7 usable), 1 "B" Door

UNIT SIZE

17-1/2" W x 31" H x 9-1/4" D*

*A" door size:

6-1/2" W x 5-1/4" H

*B" door size:

13" W x 5-1/4" H

WEIGHT

50 lbs.

**19158-09**

KEYED LOCKS	COMBO LOCKS
\$445.00	\$545.00

Surface mounted unit with
resettable combination
locks displayed

DESCRIPTION

19158-15^{1,2,3}**Cell Phone Locker**

15 "A" Doors (14 usable)

UNIT SIZE

24" W x 31" H x 9-1/4" D*

*A" door size:

6-1/2" W x 5-1/4" H

WEIGHT

60 lbs.

**19158-15**

KEYED LOCKS	COMBO LOCKS
\$680.00	\$845.00

Surface mounted unit
with master keyed
locks displayed

DESCRIPTION

19158-10^{1,2,3}**Cell Phone Locker**

10 "B" Doors (9 usable)

UNIT SIZE

30-1/2" W x 31" H x 9-1/4" D*

*B" door size:

13" W x 5-1/4" H

WEIGHT

60 lbs.

**19158-10**

KEYED LOCKS	COMBO LOCKS
\$735.00	\$845.00

Surface mounted unit
with master keyed
locks displayed

DESCRIPTION

19158-16^{1,2,3}**Cell Phone Locker**

12 "A" Doors (11 usable), 4 "B" Doors

UNIT SIZE

30-1/2" W x 31" H x 9-1/4" D*

*A" door size:

6-1/2" W x 5-1/4" H

*B" door size:

13" W x 5-1/4" H

WEIGHT

70 lbs.

**19158-16**

KEYED LOCKS	COMBO LOCKS
\$835.00	\$1,010.00

Surface mounted unit with
resettable combination
locks displayed

DESCRIPTION

19158-20^{1,2,3}**Cell Phone Locker**

20 "A" Doors (19 usable)

UNIT SIZE

30-1/2" W x 31" H x 9-1/4" D*

*A" door size:

6-1/2" W x 5-1/4" H

WEIGHT

75 lbs.

**19158-20**

KEYED LOCKS	COMBO LOCKS
\$900.00	\$1,115.00

Surface mounted unit with
resettable combination
locks displayed

DESCRIPTION

19158-25^{1,2,3}**Cell Phone Locker**

25 "A" Doors (24 usable)

UNIT SIZE

37" W x 31" H x 9-1/4" D*

*A" door size:

6-1/2" W x 5-1/4" H

WEIGHT

80 lbs.

**19158-25**

KEYED LOCKS	COMBO LOCKS
\$1,115.00	\$1,390.00

Surface mounted unit
with master keyed
locks displayed

* Recessed mounted units are 8-3/4" D

1 Specify



aluminum

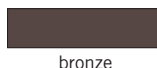

bronze



sandstone

2 Specify - surface or recessed mounted

3 Specify - master keyed locks or resettable combination locks

Note: The front access panel swings on a continuous hinge. One compartment is required for a panel lock (included) and cannot be used for cell phone storage. For multiple unit installations, all front access panel locks are keyed alike.

see cell phone
locker enclosures and
options on page 89

Custom Cell Phone Lockers

CUSTOM CELL PHONE LOCKERS

Made entirely of aluminum, Salsbury 19100 custom cell phone lockers are available in four (4) different locker door sizes and feature a durable powder coated finish. Each aluminum door includes a five (5) pin cylinder cam lock with three (3) keys or a built-in resettable combination lock and a 2" W x 5/8" H clear plastic card holder (card included) to identify the name and/or compartment number. Cell phone lockers are ideal for use in health clubs, government facilities, office buildings, schools and other settings where small personal items need to be stored safely and securely.

With Front Access:

Door panel swings on a continuous hinge. One door opening ("A" and "B" doors only) is required for a master lock and cannot be used for cell phone storage.

Without Front Access:

All openings are usable.

CUSTOM OPTIONS

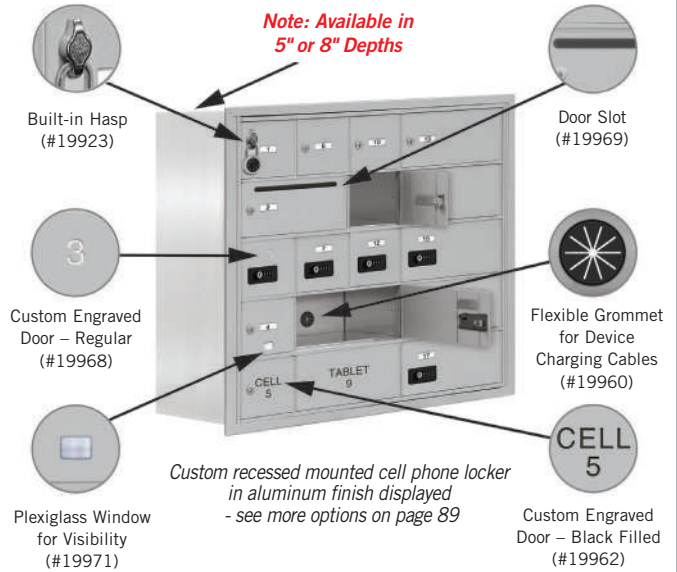

DESIGN ASSISTANCE AVAILABLE

Our design engineers are available to architects, specification writers and individuals involved in designing facilities for cell phone lockers. Our cell phone lockers can be custom manufactured for colleges and schools, country clubs, fitness centers, spas and recreational facilities.



SAMPLE CUSTOM UNIT WITH FRONT ACCESS

9 - 19100 A doors (8 usable) 2 - 19100 C doors
3 - 19100 B doors 4 - 19100 D doors

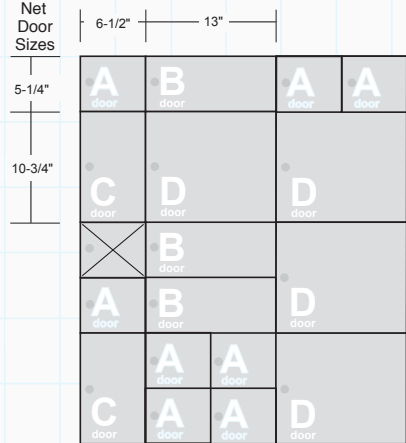

Note: There is a 1/4" vertical space between doors shown above.

ORDERING CUSTOM CELL PHONE LOCKERS (Note: Minimum order of ten (10) units)

- 1) Determine the number of openings desired using "A", "B", "C", and "D" cell phone locker doors.
- 2) Configure your requirements to fit a minimum of 2 wide x 3 high standard A doors to a maximum of 5 wide x 7 high standard A doors.
- 3) Contact us for rough opening dimensions or layout specifications.

CUSTOM CELL PHONE LOCKERS

MODEL	DESCRIPTION	DOOR SIZE	PRICE (keyed)	PRICE (resettable)
19100A ^{1,2,3,4,5}	A Door	6-1/2" W x 5-1/4" H	\$70.00	\$85.00
19100B ^{1,2,3,4,5}	B Door	13" W x 5-1/4" H	\$90.00	\$105.00
19100C ^{1,2,3,4,5}	C Door	6-1/2" W x 10-3/4" H	\$90.00	\$105.00
19100D ^{1,2,3,4,5}	D Door	13" W x 10-3/4" H	\$120.00	\$135.00

Note: The price of custom cell phone lockers is the total of each cell phone locker door within a unit. Allow approximately 2-3 weeks production time for custom cell phone lockers. For faster service, see pages 86-87 for standard cell phone lockers.

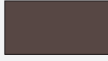
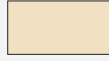
- 1 Specify  aluminum  bronze  sandstone
- 2 Specify - surface or recessed mounted
- 3 Specify - master keyed locks or resettable combination locks
- 4 Specify - with or without front access panel
- 5 Specify - 5" or 8" deep compartments

Cell Phone Locker Options & Locks

STANDARD FEATURES

Each cell phone locker features plastic card holders for door identification and either master keyed locks or resettable combination locks.

PLASTIC CARD HOLDER

- Replacement clear plastic card holder 2" W x 5/8" H (#19997 - \$3.00)

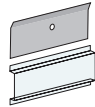

FRONT ACCESS PANEL LOCK

- Front access panel replacement lock - with (2) keys - for cell phone lockers with front access panel (#19177 - \$30.00)

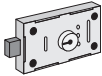

CUSTOM DOOR IDENTIFICATION

- Custom engraved placard (#19967 - \$3.00)
- Custom engraved door - regular (door will be solid - no card holder) (#19968 - \$5.00)
- Custom engraved door - black filled (door will be solid - no card holder) (#19962 - \$5.00)



DOORS

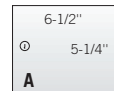

Replacement "A" door and master keyed lock (#19951K - \$45.00)



Replacement "B" door and master keyed lock (#19952K - \$55.00)



Plexiglass window 1-1/8" W x 7/8" H (#19971 - \$3.00)

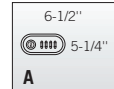

Replacement "A" door and resettable combination lock (#19951C - \$75.00)



Replacement "B" door and resettable combination lock (#19952C - \$85.00)



Door slot A and C Doors - 5-1/2" W x 3/4" H B and D Doors - 12" W x 3/4" H (#19969 - \$5.00)

CUSTOM FINISH

Custom finishes (#19966 - add 25% to unit price) are available as an option upon request. Minimum order of ten (10) units.



CUSTOM CONFIGURATIONS

- Custom door configurations
- Removable rear cover access panels
- Minimum order of ten (10) units.

MASTER KEYED LOCK

- Master keyed replacement lock - with (3) keys (#19990 - \$15.00)
- Master control key for 19990 (#19991 - \$10.00)
- Additional key per lock when ordering (#19998 - \$3.00)
- Key blanks - box of (50) (#19999 - \$50.00)

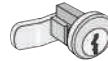

All master keyed locks can be accessed with a master control key.

RESETTABLE COMBINATION LOCK

- Resettable combination replacement lock (#19986 - \$30.00)
- Master control key (#19987 - \$10.00)



All resettable combination locks can be set to a fixed combination or a combination that can be reset after each use and can be accessed with a master control key.

ALTERNATE LOCKING SYSTEMS - FACTORY INSTALLED

- Built-in spring latch combination lock (#19910 - \$15.00)
- Master control key for 19910 (#19911 - \$10.00)
- Built-in spring latch key lock (#19915 - \$15.00)
- Master control key for 19915 (#19916 - \$10.00)
- Combination padlock with built-in hasp (#19920 - \$15.00)
- Master control key for 19920 (#19921 - \$10.00)
- Key padlock with built-in hasp (#19925 - \$15.00)
- Built-in hasp for user provided padlock (#19923 - \$10.00)



ACCESSORIES

- Locker key wristband (#19992 - \$5.00)
- Flexible grommet - 1" diameter - for device charging cables - factory installed in rear of compartment (#19960 - \$5.00)
- Pedestals for select surface mounted cell phone lockers are available on-line



CELL PHONE LOCKER ENCLOSURES - FREE-STANDING

MODEL	DESCRIPTION	UNIT SIZE	WEIGHT	PRICE
-------	-------------	-----------	--------	-------

FOR RECESSED MOUNTED CELL PHONE LOCKERS

19953 ¹	Free-Standing enclosure for #19158-15	24" W x 61" H x 9-1/4" D	70 lbs.	\$675.00
19954 ¹	Free-Standing enclosure for #19158-10, #19158-16 and #19158-20	30-1/2" W x 61" H x 9-1/4" D	75 lbs.	\$725.00
19955 ¹	Free-Standing enclosure for #19158-25	37" W x 61" H x 9-1/4" D	80 lbs.	\$775.00



19953



19954



19955

Convenient when wall mounted applications are unavailable



#19955 free-standing cell phone locker enclosure with recessed mounted cell phone lockers (#19158-25 - see page 87)

¹ Specify



aluminum



bronze



sandstone



Note: It is recommended that all free-standing enclosures be wall and/or floor anchored.