

# Resettable Combination Lock - 19986

## Operating & Resetting Instructions

### Resettable Combination Lock

The black resettable combination lock is a durable and easy-to-use lock providing resettable combination access without the need for keys. It is designed with simplicity in mind, including resetting. **Please read this entire page before use.**

The lock has a simple four (4) digit combination setting. When the lock is locked (closed), a red indicator appears in a window next to the operation knob. When the lock is unlocked (open), a green indicator appears in the window. See Figure 4.

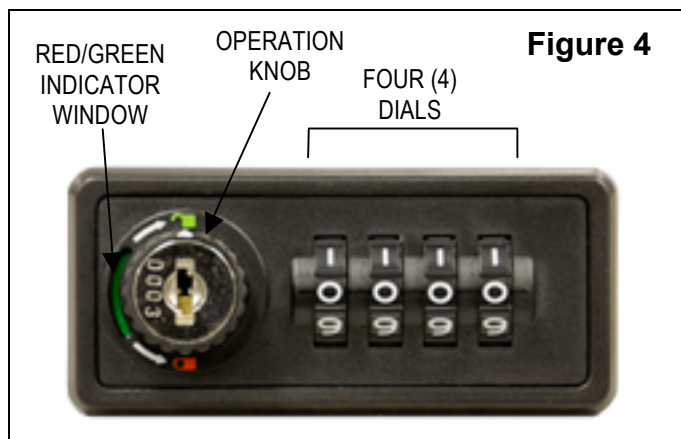

There are two (2) modes of operation: fixed combination or resettable combination. In fixed combination mode, the lock is continually opened and closed with the same custom combination that was set. In the resettable combination mode, the combination may be changed after each time the lock is opened.

The factory preset combination is 0000. Master key operation may be used at any time to open a lock.

### Setup for a Fixed Combination

1. If locked, turn the four (4) dials to the factory preset combination (0000) or the known combination that unlocks the lock.
2. Turn the operation knob clockwise 180° to the open position. The indicator in the window will turn from red to green.
3. Turn the reset/fix stem on the back of the lock from the "Fix" to the "Reset" position. See Figure 5.
4. Returning to the front of the lock, set the desired custom fixed combination on the four (4) dials.
5. On the back of the lock, return the reset/fix button back to "Fix".

*The lock is now set to continuously open using the desired custom fixed combination. After locking, scrambling the four (4) dials will secure the contents.*

### Setup for a Resettable Combination

1. If locked, turn the four (4) dials to the factory preset combination (0000) or the known combination that unlocks the lock.
2. Turn the operation knob clockwise 180° to the open position. The indicator in the window will turn from red to green.
3. Turn the reset/fix stem on the back of the lock from the "Fix" to the "Reset" position. Leave the button in this position. See Figure 5.
4. Close the door. Do not lock it.

*The lock combination can now be resettable by the user setting their own desired combination before turning the operation knob to the locked position (red window indicator). After locking, scrambling the four (4) dials will secure the contents.*

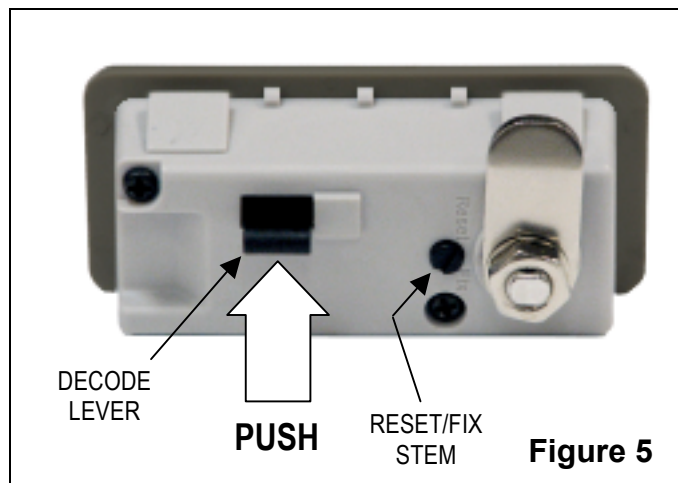

### Decode Operation

*Used to determine lock combination.*

1. Open the door. Use the master key if necessary.
2. Push the decode lever up and while holding it, rotate each of the dials on the front of the lock until it stops or there is a "click" sound. Release the decode lever.
4. Each dial will now be in the "open" combination position.

### SALSBURY INDUSTRIES

1010 East 62<sup>nd</sup> Street, Los Angeles, CA 90001-1598  
Phone: 1-800-624-5269 Int'l Phone: 323-846-6700  
Fax: 1-800-624-5299 Int'l Fax: 323-846-6800

[www.lockers.com](http://www.lockers.com)

[www.mailboxes.com](http://www.mailboxes.com)

[engineering@mailboxes.com](mailto:engineering@mailboxes.com)

[engineering@lockers.com](mailto:engineering@lockers.com)