

# 4C Horizontal Mailbox Specifications & Options

see 4C horizontal mailbox units on pages 16 - 29

- Manufactured by Salsbury Industries to USPS-STD-4C Specifications
- Required for New Construction and Major Renovations
- For Indoor or Outdoor Use
- Fully Integrated or Stand-Alone Parcel Lockers
- ADA Compliant Units Available 



- see pages 19, 23 and 27 or visit: [www.mailboxes.com/ADA-4C-Mailboxes](http://www.mailboxes.com/ADA-4C-Mailboxes)

**Volume Discount Pricing Available at Mailboxes.com!**



Custom recessed mounted 4C horizontal mailboxes in sandstone finish with optional custom engraved doors -black filled (#3774) displayed

**If Rear Loading:** The front of the outgoing mail compartment is comprised of fixed panels (no access door). The rear of the unit incorporates one or two (2) access door(s) with heavy duty latches and continuous hinges. Units are available without rear access doors upon request. Note: Rear loading access is only available for recessed mounted units.



Front view of Rear Loading Recessed Mounted Double Column Unit displayed



Rear view of Rear Loading Recessed Mounted Unit with Rear Access Doors displayed

Note: U.S.P.S. standard 4C requires a minimum of one parcel locker for every five (5) tenant compartments. Parcel lockers are not required for installation sites with less than five (5) tenant compartments.

## DESIGN ASSISTANCE

Our design engineers are available to architects, specification writers and individuals involved in the design of mail distribution facilities, apartment complexes and commercial buildings. Visit the informative Architect Resources section of our website at: [www.mailboxes.com/Architectural-Resources](http://www.mailboxes.com/Architectural-Resources) to download specifications, technical drawings, AutoCAD and BIM/Revit models. You can also submit required layout and options for a price quotation.

## 4C CONFIGURATOR

Access our 4C Configurator online at: [www.mailboxes.com/4C-Configurator](http://www.mailboxes.com/4C-Configurator) to customize units or submit your required layout for a price quotation online at [www.mailboxes.com](http://www.mailboxes.com) or to [quotes@mailboxes.com](mailto:quotes@mailboxes.com).



**If Front Loading:** Units include one or two (2) master door(s) that swing(s) on continuous integral hinges. The outgoing mail compartment includes the access door and cannot be used for mail distribution. The rear of the unit incorporates a solid rear cover.



Note: Salsbury 4C horizontal mailboxes and parcel lockers are U.S.P.S. approved and meet the specifications of USPS-STD-4C. These units are required for new construction and major renovations.

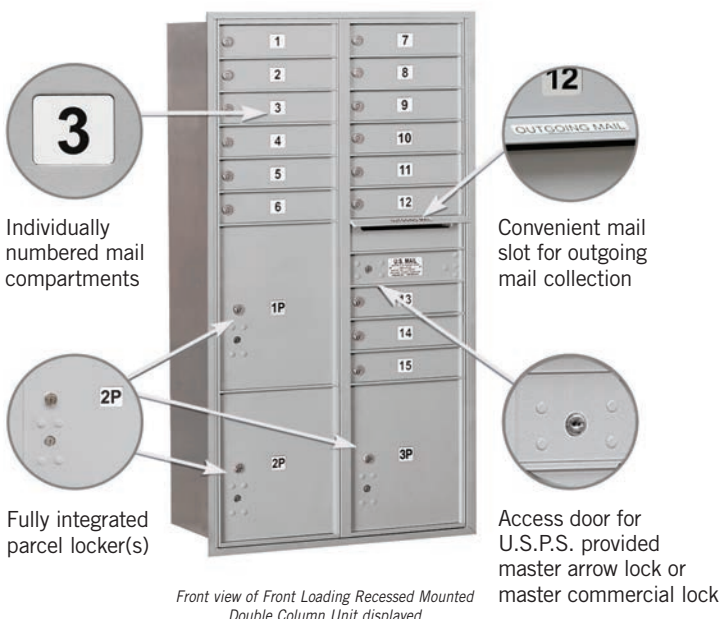

Front view of Front Loading Recessed Mounted Double Column Unit displayed

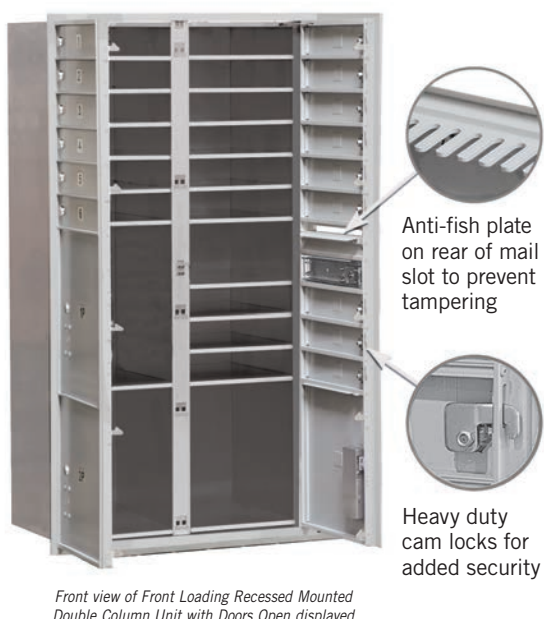

Front view of Front Loading Recessed Mounted Double Column Unit with Doors Open displayed

## 4C HORIZONTAL MAILBOX SPECIFICATIONS & OPTIONS

FOR RECESSED MOUNTED, SURFACE MOUNTED AND FREE-STANDING MAILBOX UNITS

### MAILBOX DOOR SIZES

Each aluminum door includes a heavy duty five (5) pin cylinder cam lock with a dust/rain shield and three (3) keys.

12-3/4" 3-1/4"  
**MB1** (1 High)  
#3751<sup>1</sup> Replacement MB1 door and lock \$90.00

12-3/4" 6-3/4"  
**MB2** (2 High)  
#3752<sup>1</sup> Replacement MB2 door and lock \$100.00

12-3/4" 10-1/4"  
**MB3** (3 High)  
#3753<sup>1</sup> Replacement MB3 door and lock \$115.00

12-3/4" 13-3/4"  
**MB4** (4 High)  
#3754<sup>1</sup> Replacement MB4 door and lock \$125.00

### PARCEL LOCKER DOOR SIZES

Parcel lockers offer tenants a convenient way to receive packages on site and are fit with a two (2) key security system.

12-3/4" 10-1/4"  
**PL3** (3 High)  
#3753P<sup>1</sup> Replacement PL3 door and lock \$155.00

12-3/4" 13-3/4"  
**PL4** (4 High)  
#3754P<sup>1</sup> Replacement PL4 door and lock \$160.00

12-3/4" 15-1/2"  
**PL4.5** (4.5 High)  
#3754.5P<sup>1</sup> Replacement PL4.5 door and lock \$170.00

12-3/4" 17-1/4"  
**PL5** (5 High)  
#3755P<sup>1</sup> Replacement PL5 door and lock \$175.00

12-3/4" 20-3/4"  
**PL6** (6 High)  
#3756P<sup>1</sup> Replacement PL6 door and lock \$180.00

1 Specify

- aluminum
- bronze
- sandstone
- black

### FINISHES

The durable and corrosion resistant 4C units feature a durable powder coated finish available in aluminum, bronze, sandstone or black. Custom finishes (#3766 – add 25% upcharge) are available as an option upon request – minimum order of (100) doors.

### DOOR IDENTIFICATION

Each standard 4C horizontal mailbox door has a 1" high number. The outgoing mail compartment is labeled "Outgoing Mail" and the parcel locker(s) are labeled with a "1P", "2P", etc. Custom identification systems are available as an option upon request.

### CUSTOM ENGRAVED PLACARDS

1-3/4" W x 1-1/2" H custom engraved self-adhesive placards are available as an option upon request. (#3767 - \$3.00)



### OUTGOING MAIL COMPARTMENTS

One compartment in each unit is labeled "Outgoing Mail" and includes a weather protection flap and a 11-3/4" W x 3/4" H mail slot.

### LOCKS

Each 4C mailbox door includes a heavy duty five (5) pin cylinder cam lock with a dust/rain shield and three (3) keys (2,000 different key changes). (#3790-5 - set of (5) #3790 locks - \$120.00)

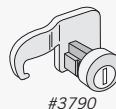

- Additional keys per lock when ordering (#3798 - \$5.00)
- Key blanks - box of (50) (#3799 - \$60.00)
- Custom lock installation - cylinders provided by owner (for installations not serviced by the U.S.P.S.) (100 door minimum) (#3793 - \$5.00 additional per door)

For installations NOT serviced by the U.S.P.S.

- Mail slots (#3769 - \$5.00)  
Standard slot size: 10-3/4" W x 3/4" H  
Custom slot sizes are available upon request.
- Plexiglass window 1-1/8" W x 7/8" H (#3771 - \$3.00)
- Outgoing mail slot plug kit (#3770 - \$35.00)

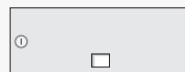
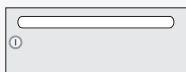

### CUSTOM ENGRAVED DOORS

- Custom engraved door – regular (#3768 - \$5.00)
- Custom engraved door – black filled (#3774 - \$5.00)

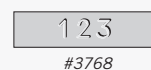

### MASTER COMMERCIAL LOCK

Factory installed if for private access - for front loading mailboxes and parcel lockers - with (2) keys (#3775 - \$30.00)

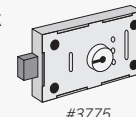

### TENANT PARCEL LOCKER LOCK

For parcel locker door - with (3) keys (#3776 - \$50.00)

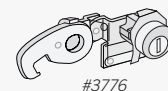

### COMBINATION LOCK

Three (3) digit single dial combination lock with spring latch and automatic throw-off (for installations not serviced by the U.S.P.S.). Combination numbers can be changed by owner. (#3786 - \$35.00)

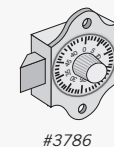

Note: Matching collection boxes and receptacle bins are available on-line.