



People Committed to Quality Since 1936®

# 4C Horizontal Mailboxes

## eBuy Product Information

### RECESSED MOUNTED 4C HORIZONTAL MAILBOXES FRONT LOADING

Made of heavy duty aluminum and stainless steel hardware, Salsbury recessed mounted 4C horizontal mailboxes and parcel lockers are U.S.P.S. approved and are available with standard MB1 mailbox doors (13-1/4" W x 3-1/4" H). All pre-numbered mailbox doors include a heavy duty cam lock with a dust/rain shield and three (3) keys. Recessed mounted 4C horizontal mailbox units include factory installed 3/4" W x 1/4" D trim and are available in configurations that are one door wide (single column) and two (2) doors wide (double column). The Salsbury maximum height units (PS-3716D-20) have two (2) fully integrated 15-1/2" high parcel lockers (PL4.5) and twenty (20) standard MB1 mailbox doors and meet the U.S.P.S. 4C requirement of one parcel locker for every ten (10) tenant compartments. Fully integrated and stand-alone parcel lockers are available in heights ranging from the equivalent of three (3) standard MB1 mailbox doors (PL3 - 10-1/4" high) to six (6) standard MB1 mailbox doors (PL6 - 20-3/4" high). Each unit includes a compartment for outgoing mail collection and is labeled "Outgoing Mail". The outgoing mail compartment includes a weather protection flap and a 10-3/4" W x 3/4" H mail slot. Designed for indoor or outdoor use, recessed mounted 4C horizontal mailboxes feature a durable powder coated aluminum finish.

### STANDARD FEATURES

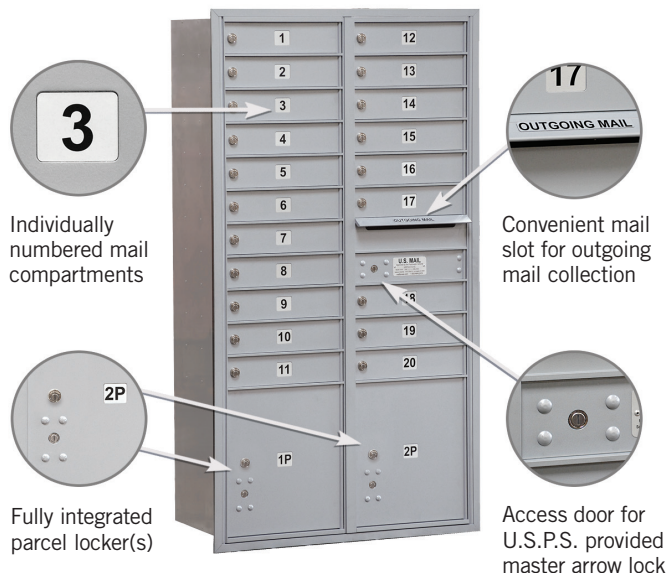

*Front view of 3716D-20 Front Loading Recessed Mounted Double Column Unit displayed*



**PS-3770**  
Outgoing Mail Slot "Plug" Kit (for 4C Mailbox Units)



# 4C Horizontal Mailboxes

**PS-3716D-20**

**PS-3711D-20**

**PS-3710D-10**

**PS-3706D-04**

## MAXIMUM HEIGHT UNITS

eBuy MODEL #	# of MAILBOXES / PARCEL LOCKERS	UNIT SIZE	WEIGHT
PS-3716D-20	20 MB1 Doors / 2 Parcel Lockers (PL4.5's)	31-1/8" W x 56-3/4" H x 17" D	170 lbs.
PS-3716D-8P	8 Parcel Lockers (PL3's, PL4's, PL5's)	31-1/8" W x 56-3/4" H x 17" D	145 lbs.
PS-3716S-09	9 MB1 Doors / 1 Parcel Locker (PL4.5)	16-3/8" W x 56-3/4" H x 17" D	85 lbs.
PS-3716S-3P	3 Parcel Lockers (PL4.5, PL5, PL6)	16-3/8" W x 56-3/4" H x 17" D	80 lbs.
PS-3716S-1C	1 Collection Box	16-3/8" W x 56-3/4" H x 17" D	125 lbs.

## 11 DOOR HIGH UNITS

eBuy MODEL #	# of MAILBOXES / PARCEL LOCKERS	UNIT SIZE	WEIGHT
PS-3711D-20	20 MB1 Doors	31-1/8" W x 41" H x 17" D	145 lbs.
PS-3711D-10	10 MB1 Doors / 2 Parcel Lockers (PL5's)	31-1/8" W x 41" H x 17" D	140 lbs.
PS-3711D-4P	4 Parcel Lockers (PL5's, PL6's)	31-1/8" W x 41" H x 17" D	135 lbs.
PS-3711S-09	9 MB1 Doors	16-3/8" W x 41" H x 17" D	75 lbs.
PS-3711S-04	4 MB1 Doors / 1 Parcel Locker (PL5)	16-3/8" W x 41" H x 17" D	70 lbs.
PS-3711S-2P	2 Parcel Lockers (PL5, PL6)	16-3/8" W x 41" H x 17" D	65 lbs.
PS-3711S-1C	1 Collection Box	16-3/8" W x 41" H x 17" D	90 lbs.

## 10 DOOR HIGH UNITS

eBuy MODEL #	# of MAILBOXES / PARCEL LOCKERS	UNIT SIZE	WEIGHT
PS-3710D-18	18 MB1 Doors	31-1/8" W x 37-1/2" H x 17" D	135 lbs.
PS-3710D-10	10 MB1 Doors / 2 Parcel Lockers (PL4, PL4.5)	31-1/8" W x 37-1/2" H x 17" D	125 lbs.
PS-3710D-4P	4 Parcel Lockers (PL5's)	31-1/8" W x 37-1/2" H x 17" D	120 lbs.
PS-3710S-08	8 MB1 Doors	16-3/8" W x 37-1/2" H x 17" D	75 lbs.
PS-3710S-04	4 MB1 Doors / 1 Parcel Locker (PL4.5)	16-3/8" W x 37-1/2" H x 17" D	75 lbs.
PS-3710S-2P	2 Parcel Lockers (PL5's)	16-3/8" W x 37-1/2" H x 17" D	65 lbs.
PS-3710S-1C	1 Collection Box	16-3/8" W x 37-1/2" H x 17" D	80 lbs.

## 6 DOOR HIGH UNITS

eBuy MODEL #	# of MAILBOXES / PARCEL LOCKERS	UNIT SIZE	WEIGHT
PS-3706D-10	10 MB1 Doors	31-1/8" W x 23-1/2" H x 17" D	90 lbs.
PS-3706D-04	4 MB1 Doors / 1 Parcel Locker (PL6)	31-1/8" W x 23-1/2" H x 17" D	80 lbs.
PS-3706D-2P	2 Parcel Lockers (PL6's)	31-1/8" W x 23-1/2" H x 17" D	80 lbs.
PS-3706S-04	4 MB1 Doors	16-3/8" W x 23-1/2" H x 17" D	50 lbs.
PS-3706S-1P	1 Parcel Locker	16-3/8" W x 23-1/2" H x 17" D	45 lbs.

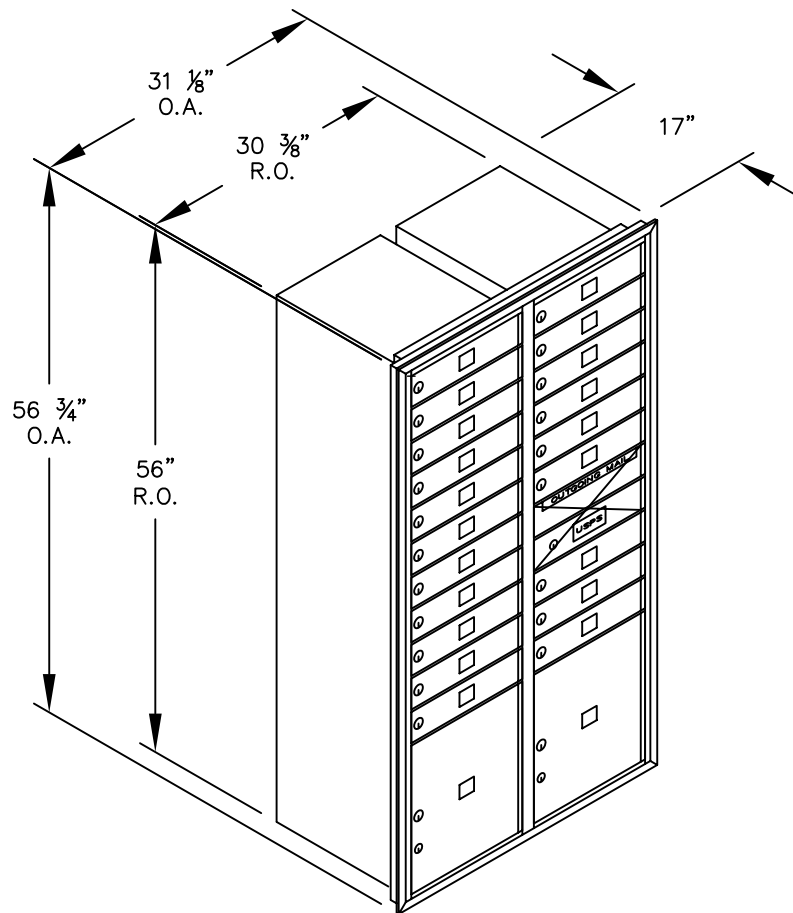

- (1) PS-3716D-20 – FRONT LOADING
- (20) 'MB1' DOORS
- (1) 'OM2' OUTGOING MAIL COMPARTMENT
- (2) PARCEL LOCKERS (15 1/2" H)

**Model #: PS-3716D-20**

4C HORIZONTAL MAILBOXES—FRONT LOADING

Contract #: 3DVDIE-13-B-0030

AVAILABLE IN ALUMINUM FINISH

AVAILABLE FOR USPS ACCESS

DRAWN: 01 / 2020

***Established in 1936, Salsbury Industries is the industry leader in manufacturing and distributing quality mailboxes.***

18300 CENTRAL AVENUE  
CARSON, CA 90746-4008  
PHONE: (800) 624-5269  
FAX: (800) 624-5299  
email: eBuy@mailboxes.com

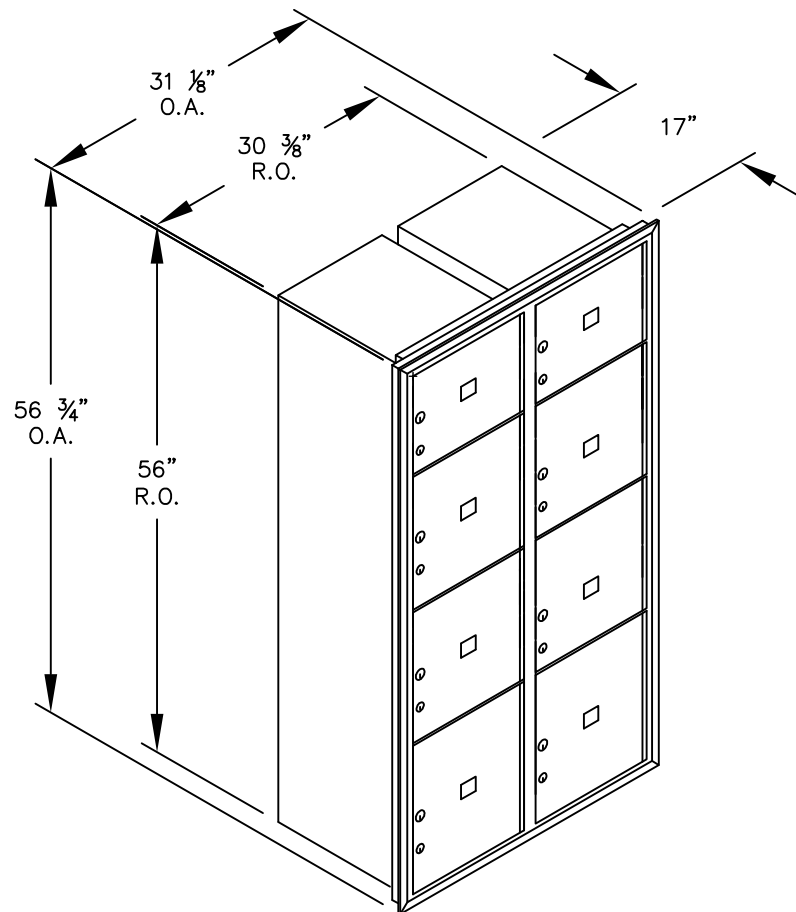

- (1) PS-3716D-8P – FRONT LOADING
- (2) PL3 PARCEL LOCKERS
- (4) PL4 PARCEL LOCKER
- (2) PL4.5 PARCEL LOCKERS

**Model #: PS-3716D-8P**

4C HORIZONTAL MAILBOXES—FRONT LOADING

Contract #: 3DVDIE-13-B-0030

AVAILABLE IN ALUMINUM FINISH

AVAILABLE FOR USPS ACCESS

DRAWN: 01/2020

***Established in 1936, Salsbury Industries is the industry leader in manufacturing and distributing quality mailboxes.***

18300 CENTRAL AVENUE  
CARSON, CA 90746-4008  
PHONE: (800) 624-5269  
FAX: (800) 624-5299  
email: eBuy@mailboxes.com



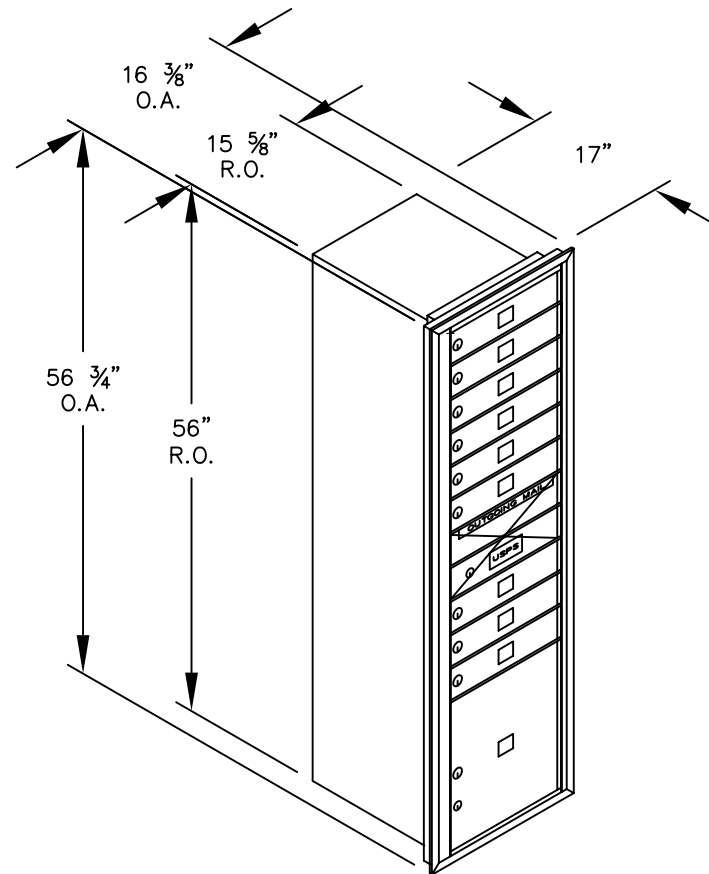

- (1) PS-3716S-09 – FRONT LOADING
- (9) 'MB1' DOORS
- (1) 'OM2' OUTGOING MAIL COMPARTMENT
- (1) PARCEL LOCKER (15 1/2" H)

**Model #: PS-3716S-09**

4C HORIZONTAL MAILBOXES—FRONT LOADING

Contract #: 3DVDIE-13-B-0030

AVAILABLE IN ALUMINUM FINISH

AVAILABLE FOR USPS ACCESS

DRAWN: 01 / 2020

***Established in 1936, Salsbury Industries is the industry leader in manufacturing and distributing quality mailboxes.***

18300 CENTRAL AVENUE  
 CARSON, CA 90746-4008  
 PHONE: (800) 624-5269  
 FAX: (800) 624-5299  
 email: eBuy@mailboxes.com

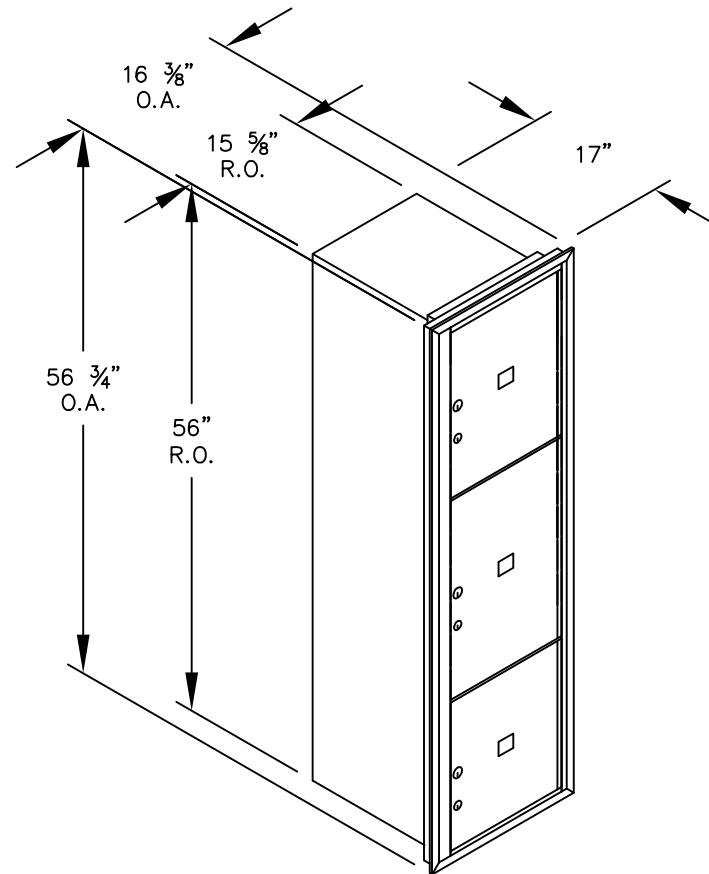

(1) PS-3716S-3P – FRONT LOADING

(1) PL4.5 PARCEL LOCKER

(1) PL5 PARCEL LOCKER

(1) PL6 PARCEL LOCKER

**Model #: PS-3716S-3P**

4C HORIZONTAL MAILBOXES—FRONT LOADING

Contract #: 3DVDIE-13-B-0030

AVAILABLE IN ALUMINUM FINISH

AVAILABLE FOR USPS ACCESS

DRAWN: 01 / 2020

***Established in 1936, Salsbury Industries is the industry leader in manufacturing and distributing quality mailboxes.***

18300 CENTRAL AVENUE  
CARSON, CA 90746-4008  
PHONE: (800) 624-5269  
FAX: (800) 624-5299  
email: eBuy@mailboxes.com

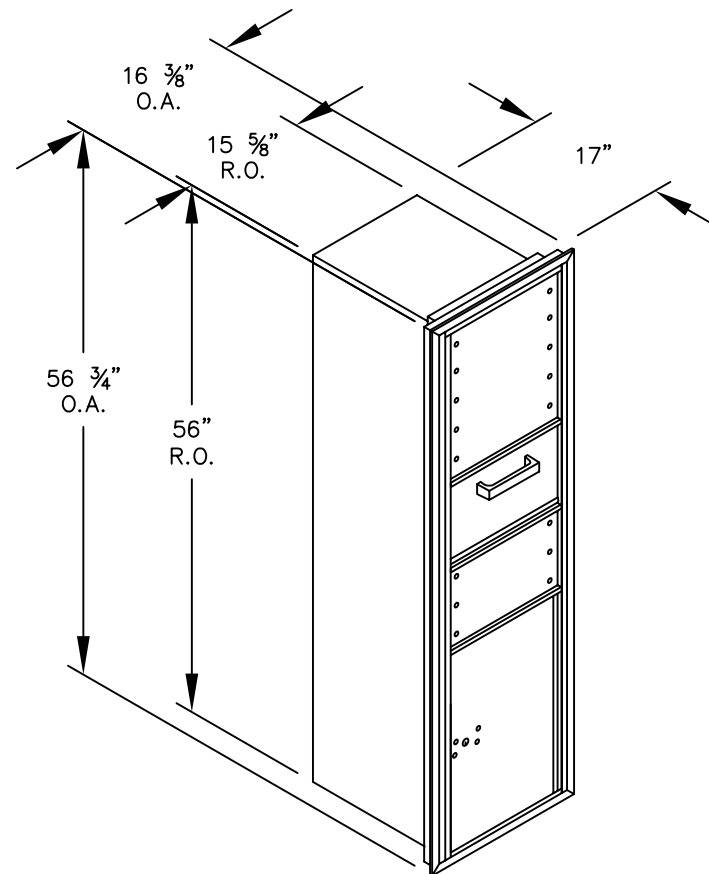

- (1) PS-3716S-1C – FRONT LOADING
- (1) HOPPER DOOR (12" W x 7-5/8" H)

**Model #: PS-3716S-1C**

4C HORIZONTAL COLLECTION UNIT – FRONT LOADING

Contract #: 3DVDIE-13-B-0030

AVAILABLE IN ALUMINUM FINISH

AVAILABLE FOR USPS ACCESS

DRAWN: 01 / 2020

***Established in 1936, Salsbury Industries is the industry leader in manufacturing and distributing quality mailboxes.***

18300 CENTRAL AVENUE  
CARSON, CA 90746-4008  
PHONE: (800) 624-5269  
FAX: (800) 624-5299  
email: eBuy@mailboxes.com

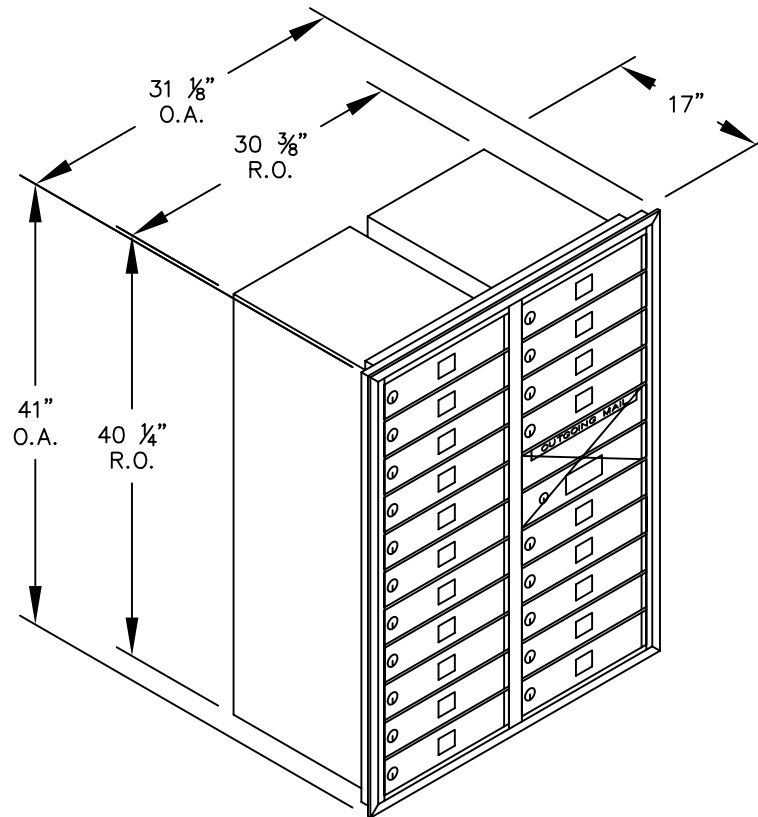

(1) PS-3711D-20 – FRONT LOADING

(20) 'MB1' DOORS

(1) 'OM2' OUTGOING MAIL COMPARTMENT

**Model #: PS-3711D-20**

4C HORIZONTAL MAILBOXES—FRONT LOADING

Contract #: 3DVDIE-13-B-0030

AVAILABLE IN ALUMINUM FINISH

AVAILABLE FOR USPS ACCESS

DRAWN: 01 / 2020

***Established in 1936, Salsbury Industries is the industry leader in manufacturing and distributing quality mailboxes.***

18300 CENTRAL AVENUE  
CARSON, CA 90746-4008  
PHONE: (800) 624-5269  
FAX: (800) 624-5299  
email: eBuy@mailboxes.com



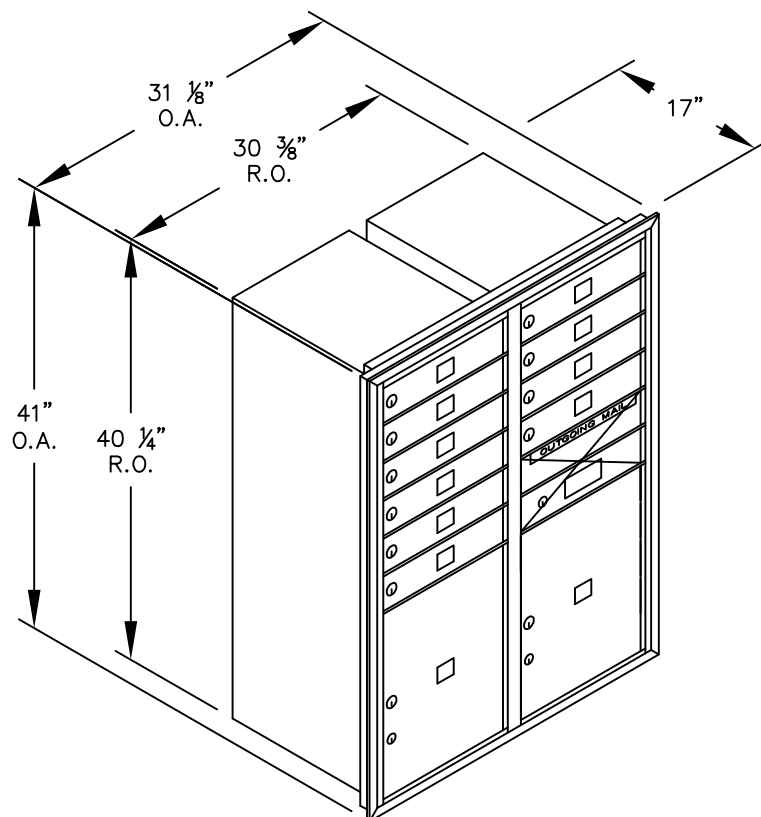

- (1) PS-3711D-10 – FRONT LOADING
- (10) 'MB1' DOORS
- (1) 'OM2' OUTGOING MAIL COMPARTMENT
- (2) PL5 PARCEL LOCKERS

Model #: PS-3711D-10

4C HORIZONTAL MAILBOXES—FRONT LOADING

Contract #: 3DVDIE-13-B-0030

AVAILABLE IN ALUMINUM FINISH

AVAILABLE FOR USPS ACCESS

DRAWN: 01 / 2020

***Established in 1936, Salsbury Industries is the industry leader in manufacturing and distributing quality mailboxes.***

18300 CENTRAL AVENUE  
CARSON, CA 90746-4008  
PHONE: (800) 624-5269  
FAX: (800) 624-5299  
email: eBuy@mailboxes.com

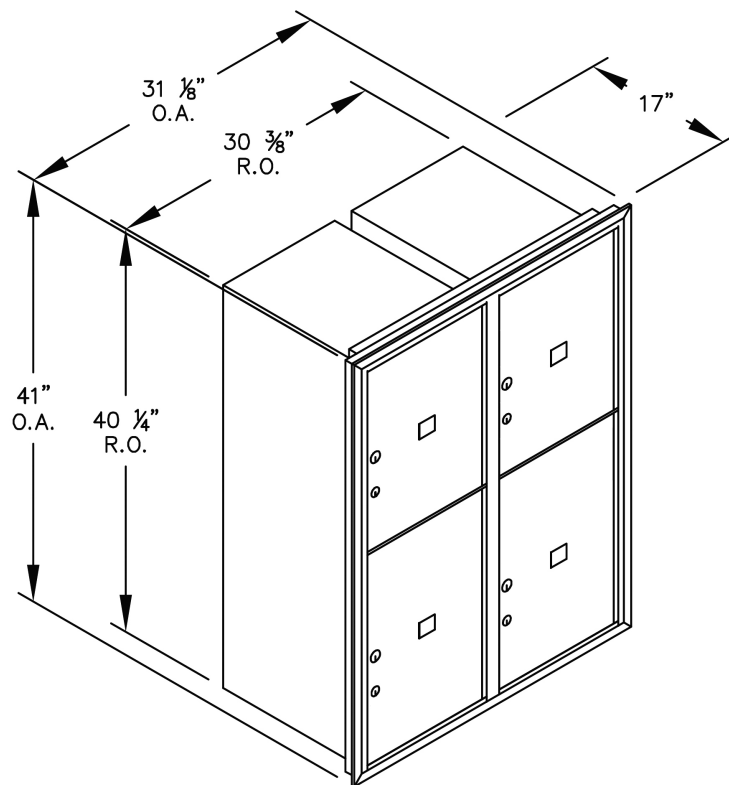

(1) PS-3711D-4P – FRONT LOADING

(2) PL5 PARCEL LOCKERS

(2) PL6 PARCEL LOCKERS

**Model #: PS-3711D-4P**

4C HORIZONTAL MAILBOXES—FRONT LOADING

Contract #: 3DVDIE-13-B-0030

AVAILABLE IN ALUMINUM FINISH

AVAILABLE FOR USPS ACCESS

DRAWN: 01 / 2020

***Established in 1936, Salsbury Industries is the industry leader in manufacturing and distributing quality mailboxes.***

18300 CENTRAL AVENUE  
CARSON, CA 90746-4008  
PHONE: (800) 624-5269  
FAX: (800) 624-5299  
email: eBuy@mailboxes.com

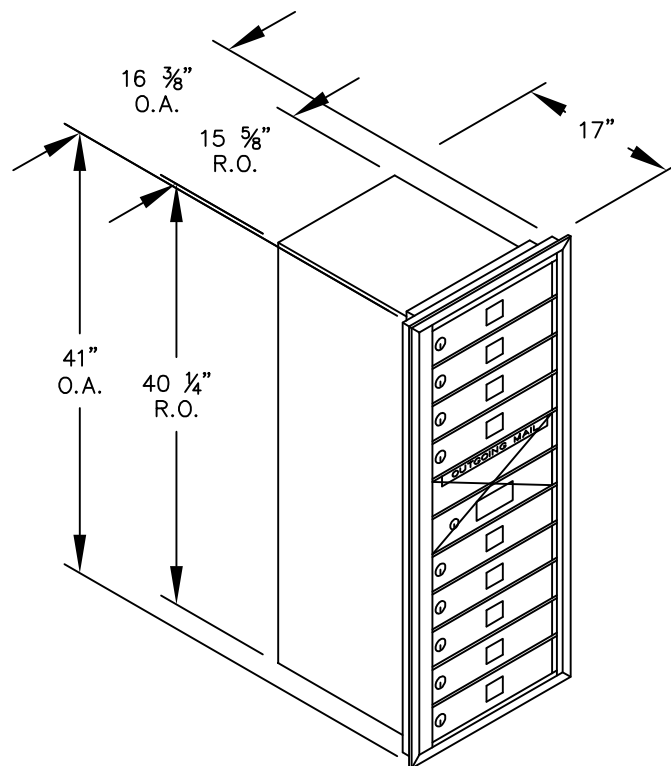

(1) PS-3711S-09 – FRONT LOADING

(9) 'MB1' DOORS

(1) 'OM2' OUTGOING MAIL COMPARTMENT

**Model #: PS-3711S-09**

4C HORIZONTAL MAILBOXES—FRONT LOADING

Contract #: 3DVDIE-13-B-0030

AVAILABLE IN ALUMINUM FINISH

AVAILABLE FOR USPS ACCESS

DRAWN: 01 / 2020

***Established in 1936, Salsbury Industries is the industry leader in manufacturing and distributing quality mailboxes.***

18300 CENTRAL AVENUE  
CARSON, CA 90746-4008  
PHONE: (800) 624-5269  
FAX: (800) 624-5299  
email: eBuy@mailboxes.com

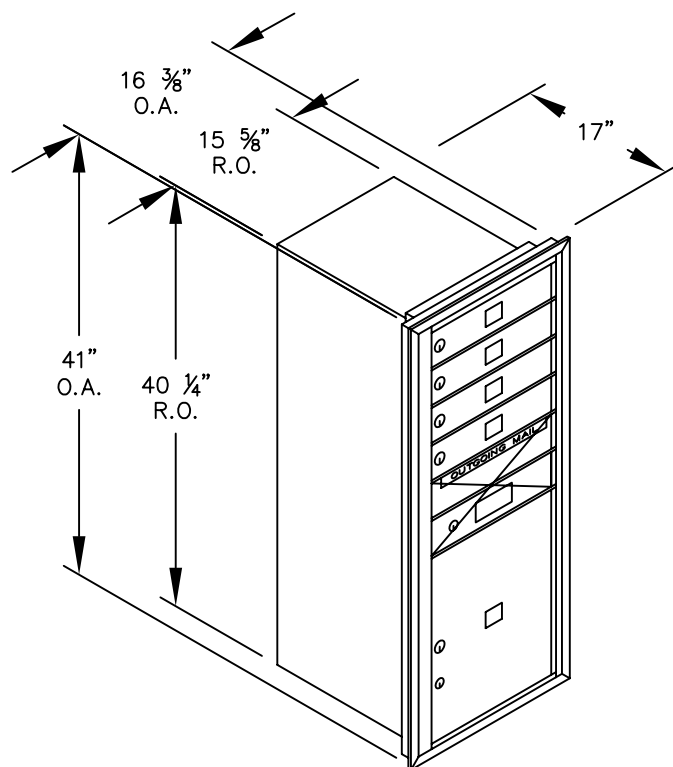

(1) PS-3711S-04 – FRONT LOADING

- (4) 'MB1' DOORS
- (1) 'OM2' OUTGOING MAIL COMPARTMENT
- (1) PL5 PARCEL LOCKER

**Model #: PS-3711S-04**

4C HORIZONTAL MAILBOXES—FRONT LOADING

Contract #: 3DVDIE-13-B-0030

AVAILABLE IN ALUMINUM FINISH

AVAILABLE FOR USPS ACCESS

DRAWN: 01 / 2020

***Established in 1936, Salsbury Industries is the industry leader in manufacturing and distributing quality mailboxes.***

18300 CENTRAL AVENUE  
CARSON, CA 90746-4008  
PHONE: (800) 624-5269  
FAX: (800) 624-5299  
email: eBuy@mailboxes.com

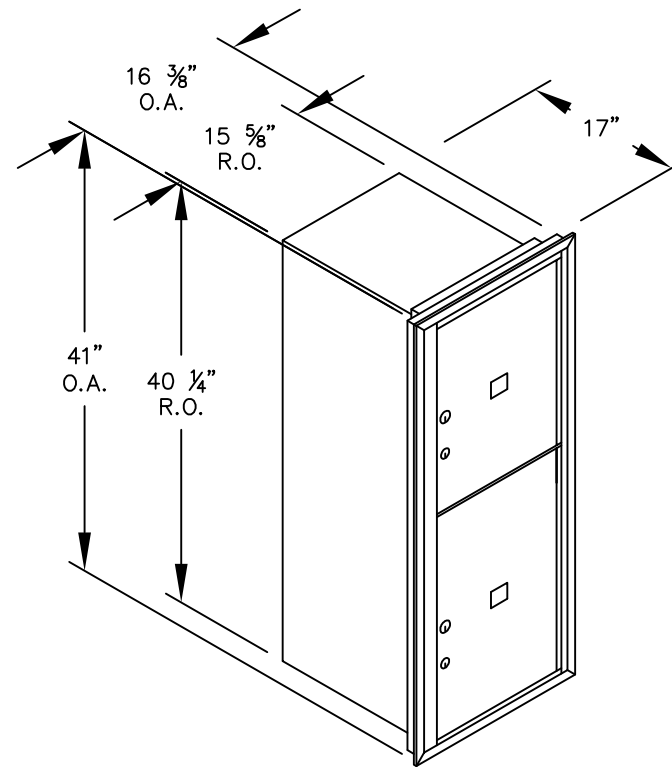

(1) PS-3711S-2P – FRONT LOADING

(1) PL5 PARCEL LOCKER  
(1) PL6 PARCEL LOCKER

**Model #: PS-3711S-2P**

4C HORIZONTAL MAILBOXES—FRONT LOADING

Contract #: 3DVDIE-13-B-0030

AVAILABLE IN ALUMINUM FINISH

AVAILABLE FOR USPS ACCESS

DRAWN: 01 / 2020

***Established in 1936, Salsbury Industries is the industry leader in manufacturing and distributing quality mailboxes.***

18300 CENTRAL AVENUE  
CARSON, CA 90746-4008  
PHONE: (800) 624-5269  
FAX: (800) 624-5299  
email: eBuy@mailboxes.com

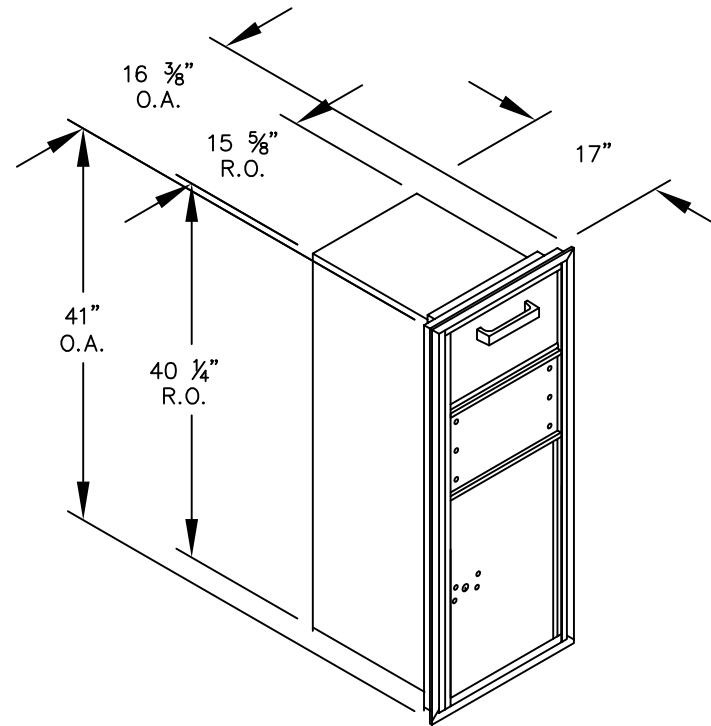

- (1) PS-3711S-1C – FRONT LOADING
- (1) HOPPER DOOR (12\"/>

**Model #: PS-3711S-1C**

4C HORIZONTAL COLLECTION UNIT – FRONT LOADING  
Contract #: 3DVDIE-13-B-0030

AVAILABLE IN ALUMINUM FINISH  
AVAILABLE FOR USPS ACCESS

DRAWN: 01 / 2020

***Established in 1936, Salsbury Industries is the industry leader in manufacturing and distributing quality mailboxes.***

18300 CENTRAL AVENUE  
CARSON, CA 90746-4008  
PHONE: (800) 624-5269  
FAX: (800) 624-5299  
email: eBuy@mailboxes.com



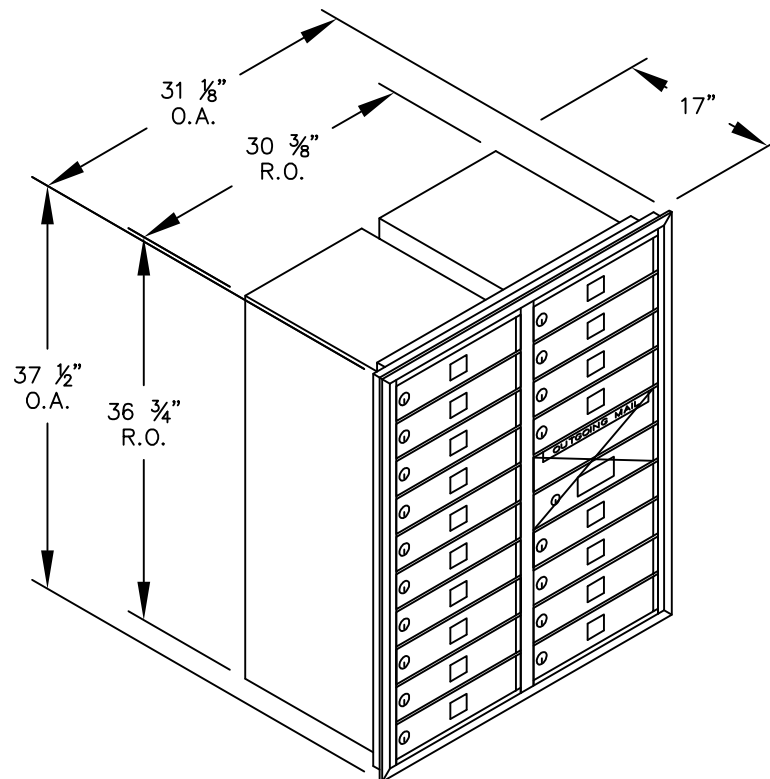

- (1) PS-3710D-18 – FRONT LOADING
- (18) 'MB1' DOORS
- (1) 'OM2' OUTGOING MAIL COMPARTMENT

**Model #: PS-3710D-18**

4C HORIZONTAL MAILBOXES—FRONT LOADING

Contract #: 3DVDIE-13-B-0030

AVAILABLE IN ALUMINUM FINISH

AVAILABLE FOR USPS ACCESS

DRAWN: 01 / 2020

***Established in 1936, Salsbury Industries is the industry leader in manufacturing and distributing quality mailboxes.***

18300 CENTRAL AVENUE  
CARSON, CA 90746-4008  
PHONE: (800) 624-5269  
FAX: (800) 624-5299  
email: eBuy@mailboxes.com

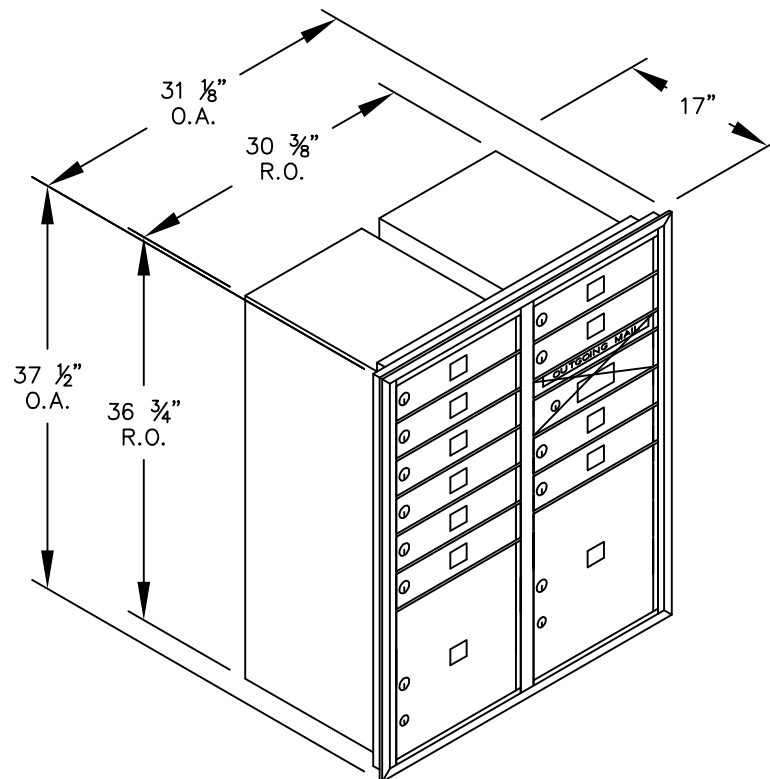

- (1) PS-3710D-10 – FRONT LOADING
- (10) 'MB1' DOORS
- (1) 'OM1.5' OUTGOING MAIL COMPARTMENT
- (1) PL4 PARCEL LOCKER (13 3/4" H)
- (1) PL4.5 PARCEL LOCKER (15 1/2" H)

Model #: PS-3710D-10

4C HORIZONTAL MAILBOXES—FRONT LOADING

Contract #: 3DVDIE-13-B-0030

AVAILABLE IN ALUMINUM FINISH

AVAILABLE FOR USPS ACCESS

DRAWN: 01 / 2020

***Established in 1936, Salsbury Industries is the industry leader in manufacturing and distributing quality mailboxes.***

18300 CENTRAL AVENUE  
CARSON, CA 90746-4008  
PHONE: (800) 624-5269  
FAX: (800) 624-5299  
email: eBuy@mailboxes.com

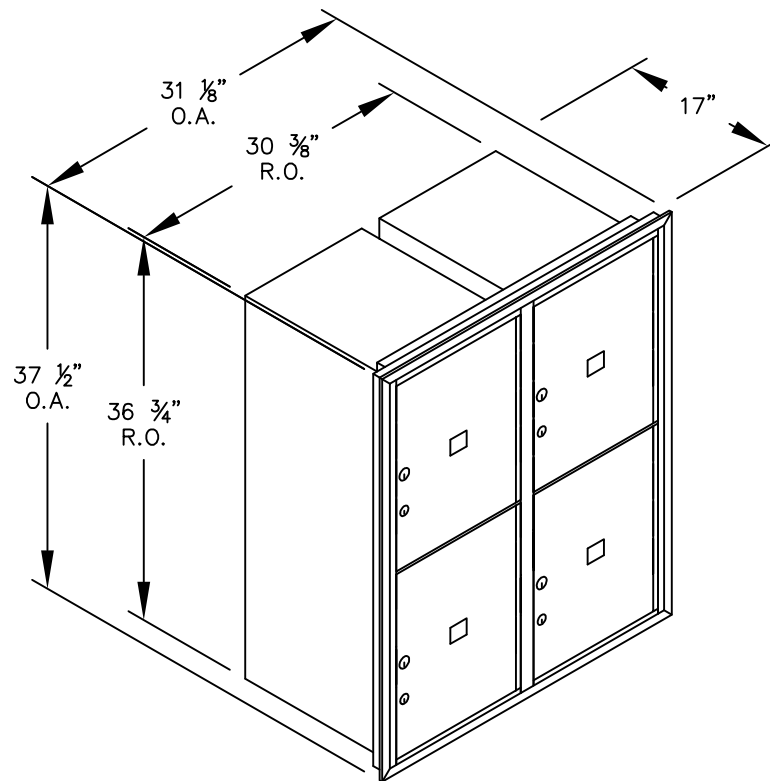

- (1) PS-3710D-4P – FRONT LOADING
- (4) PL5 PARCEL LOCKERS

**Model #: PS-3710D-4P**

4C HORIZONTAL MAILBOXES—FRONT LOADING

Contract #: 3DVDIE-13-B-0030

AVAILABLE IN ALUMINUM FINISH

AVAILABLE FOR USPS ACCESS

DRAWN: 01 / 2020

***Established in 1936, Salsbury Industries is the industry leader in manufacturing and distributing quality mailboxes.***

18300 CENTRAL AVENUE  
CARSON, CA 90746-4008  
PHONE: (800) 624-5269  
FAX: (800) 624-5299  
email: eBuy@mailboxes.com

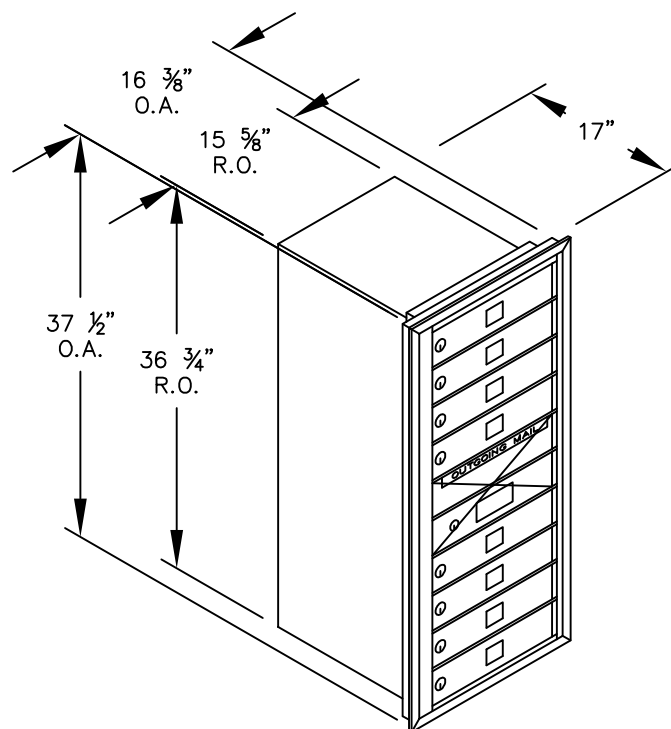

(1) PS-3710S-08 – FRONT LOADING

(8) 'MB1' DOORS

(1) 'OM2' OUTGOING MAIL COMPARTMENT

Model #: PS-3710S-08

4C HORIZONTAL MAILBOXES—FRONT LOADING

Contract #: 3DVDIE-13-B-0030

AVAILABLE IN ALUMINUM FINISH

AVAILABLE FOR USPS ACCESS

DRAWN: 01 / 2020

***Established in 1936, Salsbury Industries is the industry leader in manufacturing and distributing quality mailboxes.***

18300 CENTRAL AVENUE  
CARSON, CA 90746-4008  
PHONE: (800) 624-5269  
FAX: (800) 624-5299  
email: eBuy@mailboxes.com

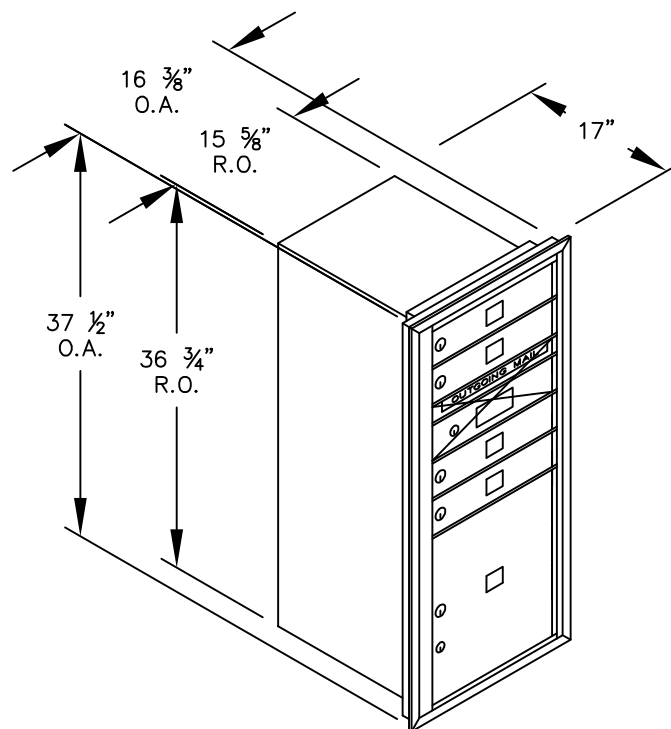

(1) PS-3710S-04 – FRONT LOADING

(4) 'MB1' DOORS

(1) 'OM1.5' OUTGOING MAIL COMPARTMENT

(1) PL4.5 PARCEL LOCKER (15 1/2" H)

Model #: PS-3710S-04

4C HORIZONTAL MAILBOXES—FRONT LOADING

Contract #: 3DVDIE-13-B-0030

AVAILABLE IN ALUMINUM FINISH

AVAILABLE FOR USPS ACCESS

DRAWN: 01 / 2020

***Established in 1936, Salsbury Industries is the industry leader in manufacturing and distributing quality mailboxes.***

18300 CENTRAL AVENUE  
CARSON, CA 90746-4008  
PHONE: (800) 624-5269  
FAX: (800) 624-5299  
email: eBuy@mailboxes.com

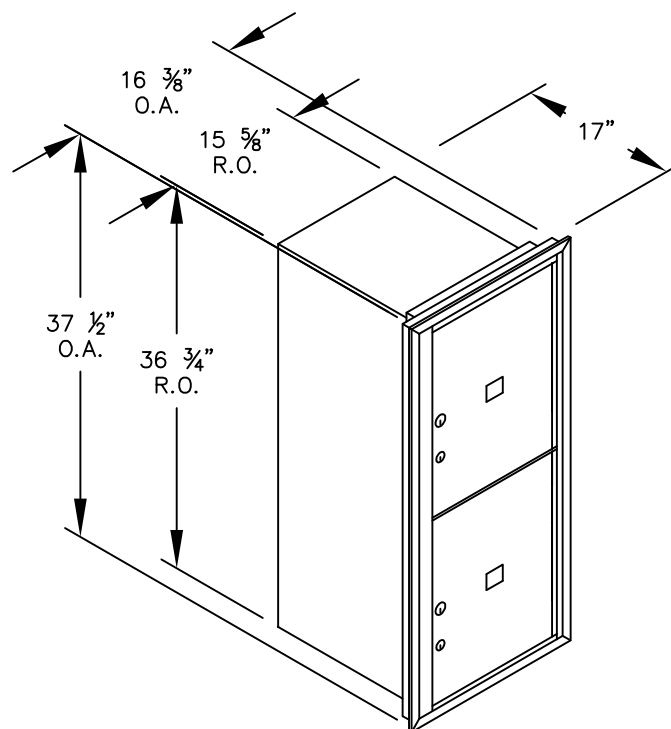

(1) PS-3710S-2P – FRONT LOADING

(2) PL5 PARCEL LOCKERS

**Model #: PS-3710S-2P**

4C HORIZONTAL MAILBOXES—FRONT LOADING

Contract #: 3DVDIE-13-B-0030

AVAILABLE IN ALUMINUM FINISH

AVAILABLE FOR USPS ACCESS

DRAWN: 01 / 2020

***Established in 1936, Salsbury Industries is the industry leader in manufacturing and distributing quality mailboxes.***

18300 CENTRAL AVENUE  
CARSON, CA 90746-4008  
PHONE: (800) 624-5269  
FAX: (800) 624-5299  
email: eBuy@mailboxes.com



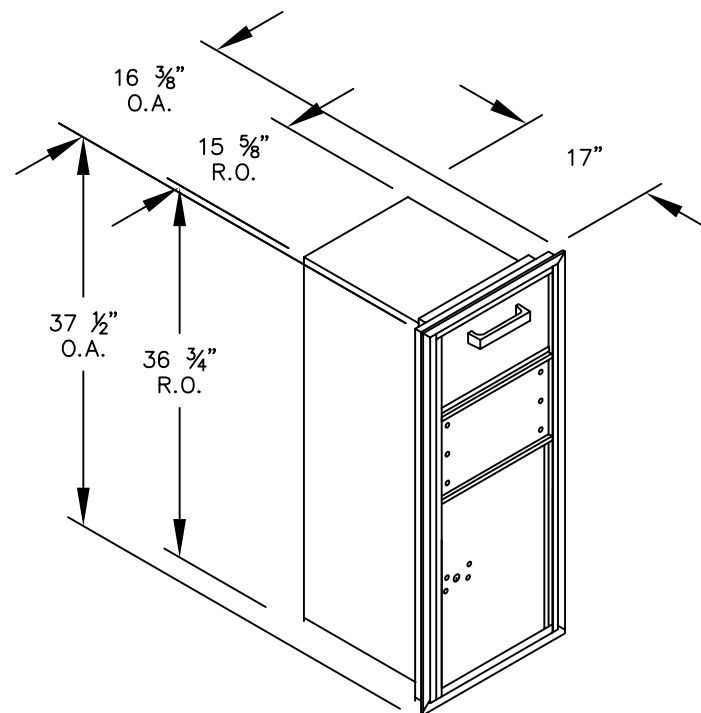

(1) PS-3710S-1C – FRONT LOADING

(1) HOPPER DOOR (12\"/>

Model #: PS-3710S-1C

4C HORIZONTAL COLLECTION UNIT – FRONT LOADING

Contract #: 3DVDIE-13-B-0030

AVAILABLE IN ALUMINUM FINISH

AVAILABLE FOR USPS ACCESS

DRAWN: 01 / 2020

***Established in 1936, Salsbury Industries is the industry leader in manufacturing and distributing quality mailboxes.***

18300 CENTRAL AVENUE  
CARSON, CA 90746-4008  
PHONE: (800) 624-5269  
FAX: (800) 624-5299  
email: eBuy@mailboxes.com

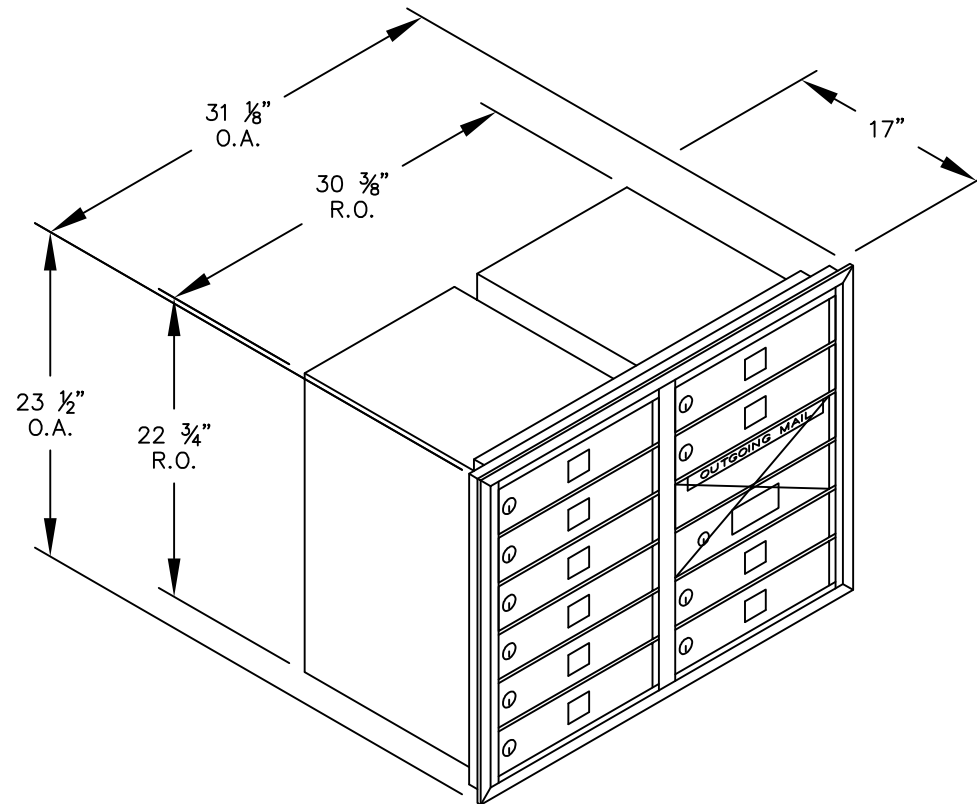

(1) PS-3706D-10 – FRONT LOADING

(10) 'MB1' DOORS

(1) 'OM2' OUTGOING MAIL COMPARTMENT

**Model #: PS-3706D-10**

4C HORIZONTAL MAILBOXES—FRONT LOADING

Contract #: 3DVDIE-13-B-0030

AVAILABLE IN ALUMINUM FINISH

AVAILABLE FOR USPS ACCESS

DRAWN: 01 / 2020

***Established in 1936, Salsbury Industries is the industry leader in manufacturing and distributing quality mailboxes.***

18300 CENTRAL AVENUE  
CARSON, CA 90746-4008  
PHONE: (800) 624-5269  
FAX: (800) 624-5299  
email: eBuy@mailboxes.com

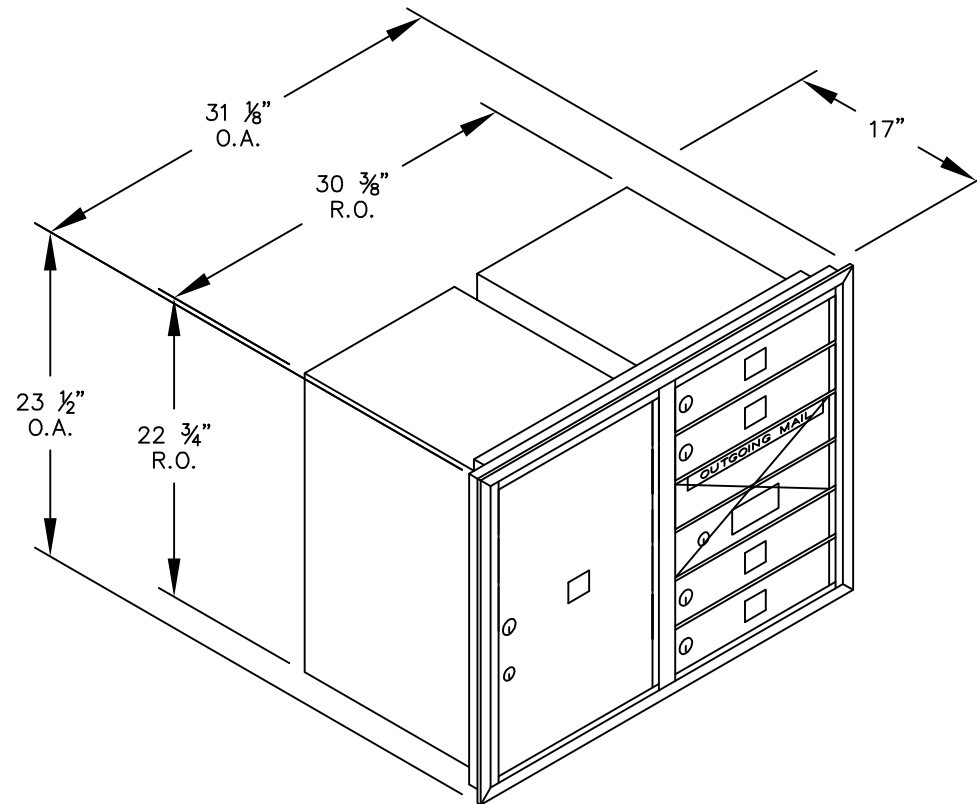

(1) PS-3706D-04 – FRONT LOADING

- (4) 'MB1' DOORS
- (1) 'OM2' OUTGOING MAIL COMPARTMENT
- (1) 'PL6' PARCEL LOCKER

Model #: PS-3706D-04

4C HORIZONTAL MAILBOXES—FRONT LOADING

Contract #: 3DVDIE-13-B-0030

AVAILABLE IN ALUMINUM FINISH

AVAILABLE FOR USPS ACCESS

DRAWN: 01 / 2020

***Established in 1936, Salsbury Industries is the industry leader in manufacturing and distributing quality mailboxes.***

18300 CENTRAL AVENUE  
CARSON, CA 90746-4008  
PHONE: (800) 624-5269  
FAX: (800) 624-5299  
email: eBuy@mailboxes.com

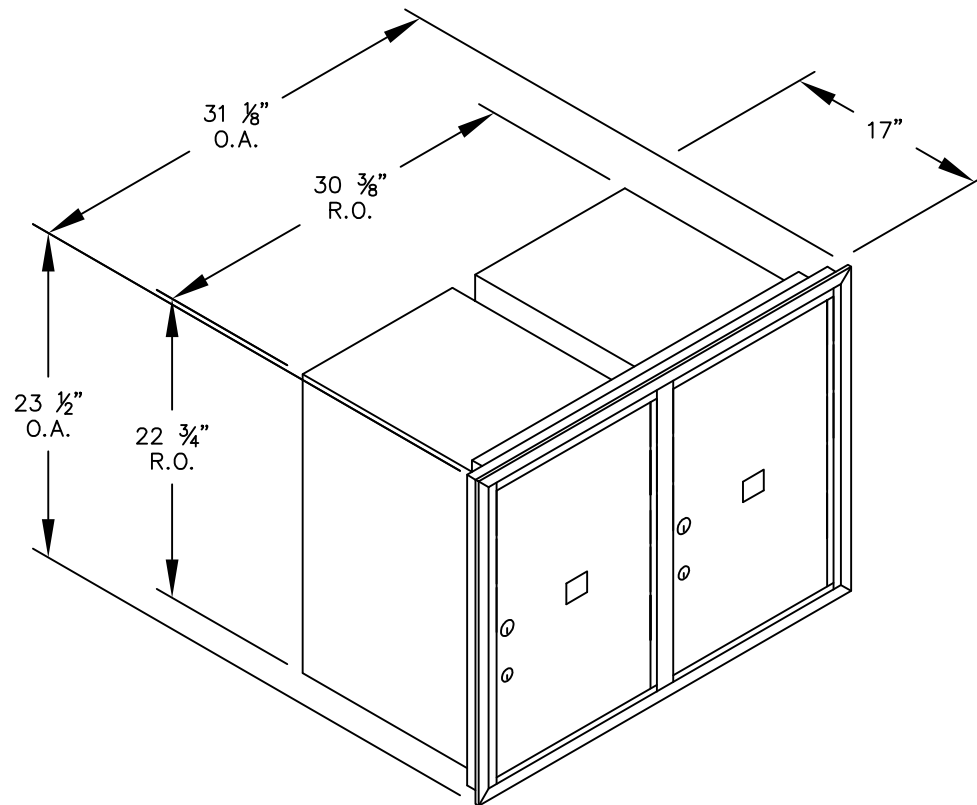

(1) PS-3706D-2P – FRONT LOADING

(2) 'PL6' PARCEL LOCKERS

**Model #: PS-3706D-2P**

4C HORIZONTAL MAILBOXES—FRONT LOADING

Contract #: 3DVDIE-13-B-0030

AVAILABLE IN ALUMINUM FINISH

AVAILABLE FOR USPS ACCESS

DRAWN: 01 / 2020

***Established in 1936, Salsbury Industries is the industry leader in manufacturing and distributing quality mailboxes.***

18300 CENTRAL AVENUE  
CARSON, CA 90746-4008  
PHONE: (800) 624-5269  
FAX: (800) 624-5299  
email: eBuy@mailboxes.com

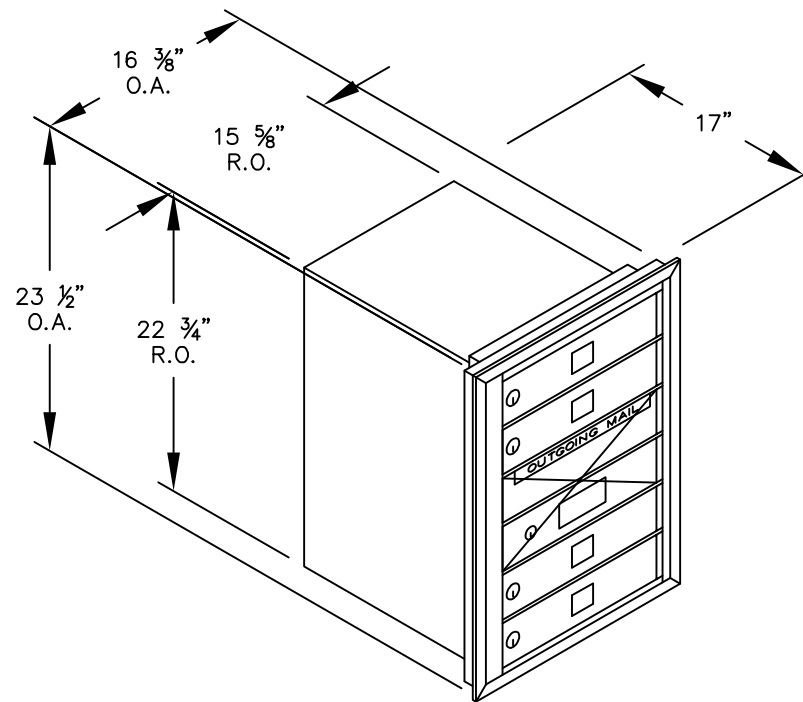

(1) PS-3706S-04 – FRONT LOADING

(4) 'MB1' DOORS

(1) 'OM2' OUTGOING MAIL COMPARTMENT

Model #: PS-3706S-04

4C HORIZONTAL MAILBOXES—FRONT LOADING

Contract #: 3DVDIE-13-B-0030

AVAILABLE IN ALUMINUM FINISH

AVAILABLE FOR USPS ACCESS

DRAWN: 01 / 2020

***Established in 1936, Salsbury Industries is the industry leader in manufacturing and distributing quality mailboxes.***

18300 CENTRAL AVENUE  
CARSON, CA 90746-4008  
PHONE: (800) 624-5269  
FAX: (800) 624-5299  
email: eBuy@mailboxes.com

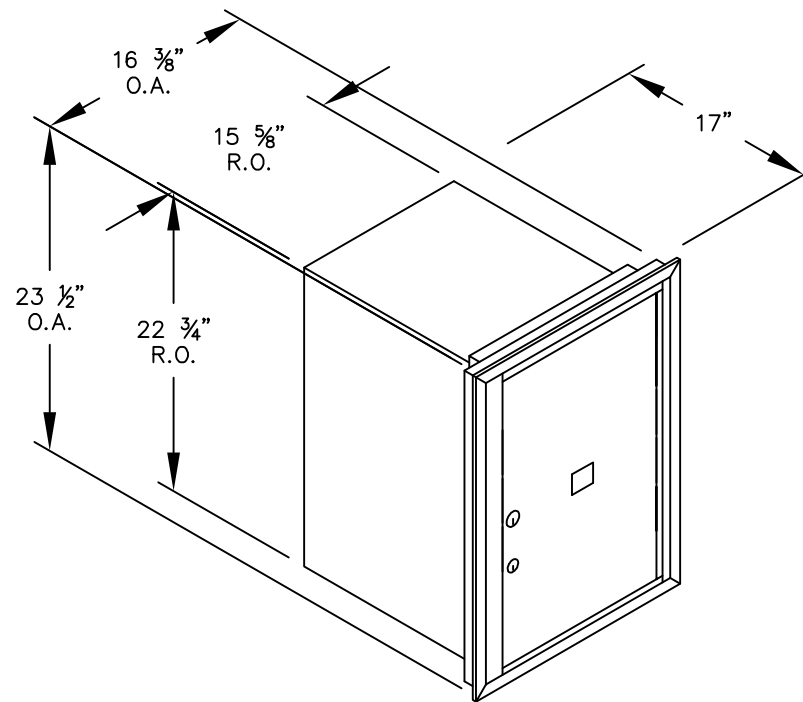

(1) PS-3706S-1P – FRONT LOADING

(1) 'PL6' PARCEL LOCKER

**Model #: PS-3706S-1P**

4C HORIZONTAL MAILBOXES—FRONT LOADING

Contract #: 3DVDIE-13-B-0030

AVAILABLE IN ALUMINUM FINISH

AVAILABLE FOR USPS ACCESS

DRAWN: 01 / 2020

***Established in 1936, Salsbury Industries is the industry leader in manufacturing and distributing quality mailboxes.***

18300 CENTRAL AVENUE  
CARSON, CA 90746-4008  
PHONE: (800) 624-5269  
FAX: (800) 624-5299  
email: eBuy@mailboxes.com