

Cell Phone Lockers - 19000 Series

Wall Mount or Counter Top Mount Installation Instructions

Made entirely of extruded and sheet aluminum, Salsbury Industries' 19000 series cell phone lockers are powder coated and will provide years of maintenance free service. *See page 2 for operation of resettable combination lock.*

Wall Mount or Counter Top Mount

Each cell phone locker is comprised of two (2) major components preassembled in the factory: the housing and the inner locker cabinet. Prior to installation, the inner locker cabinet is removed from the housing. The housing is installed first, either on a wall, on a counter top, or on both. Then the inner locker cabinet is reinstalled into the housing.

Inner Locker Cabinet Removal

To remove the inner locker cabinet from the housing, open the four (4) corner doors. Remove the screw in each compartment as shown in Figure 1 below. Set the screws aside, as they will be used later to reinstall the inner locker cabinet into the housing. Lift the inner locker cabinet out of the housing and set it aside. Close the four (4) corner doors, but leave the keys in the locks.



Figure 1

Housing Installation

The housing may be installed on the surface of a wall at an appropriate height from the floor, on a table or counter top, or both. **It is the installer's responsibility to ensure the unit is properly anchored to prevent tearing out of a wall or tipping over on a table or counter top.**

Due to the construction variations in mounting surfaces, fasteners and anchors are not provided. Choose appropriate hardware for the particular conditions of each installation. Likewise, holes are not provided in the rear or bottom walls of the housing. Select appropriate hole locations and drill holes.

It is important for safety reasons to use at least four (4) fasteners and place one of them in each of the four (4) corners of the mounting surface (either on the rear panel or the bottom panel or both - see Figure 2). Ensure that all fasteners are securely tightened.

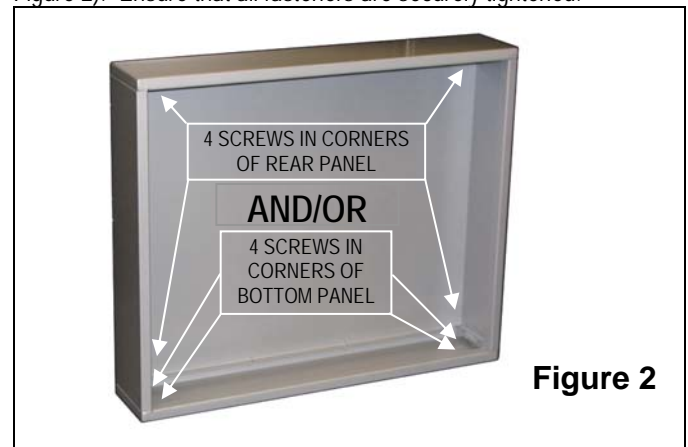

Figure 2

Inner Locker Cabinet Insertion

Place the bottom edge of the inner locker cabinet into the housing so that it is contacting the front of the housing - see Figure 3. Rotate the top of the inner locker cabinet back into the top of the housing. There should be no gap between the inner locker cabinet front frame and the front edge of the housing.

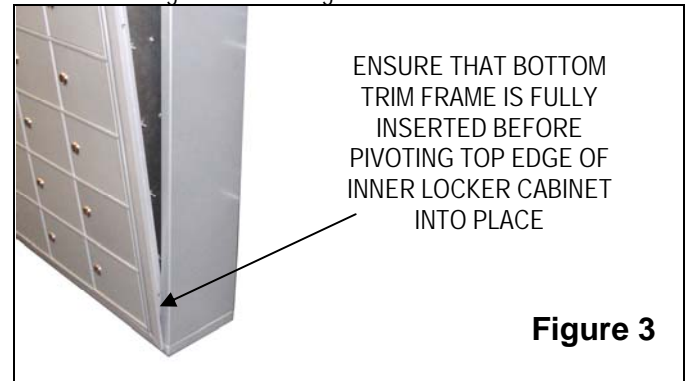

Figure 3

Reinstall Inner Locker Cabinet into Housing

Open the four (4) corner doors of the inner locker cabinet. Replace the four (4) screws that were removed earlier. Close and lock the four (4) corner doors. The installation is now complete.

SALSBURY INDUSTRIES

1010 East 62nd Street, Los Angeles, CA 90001-1598
 Phone: 1-800-624-5269 Int'l Phone: 323-846-6700
 Fax: 1-800-624-5299 Int'l Fax: 323-846-6800

www.lockers.com

www.mailboxes.com

engineering@mailboxes.com

engineering@lockers.com

Resettable Combination Lock

The black resettable combination lock is a durable and easy-to-use lock providing resettable combination access without the need for keys. It is designed with simplicity in mind, including resetting. *Please read this entire page before use.*

The lock has a simple four (4) digit combination setting. When the lock is locked (closed), a red indicator appears in a window next to the operation knob. When the lock is unlocked (open), a green indicator appears in the window. See Figure 4.

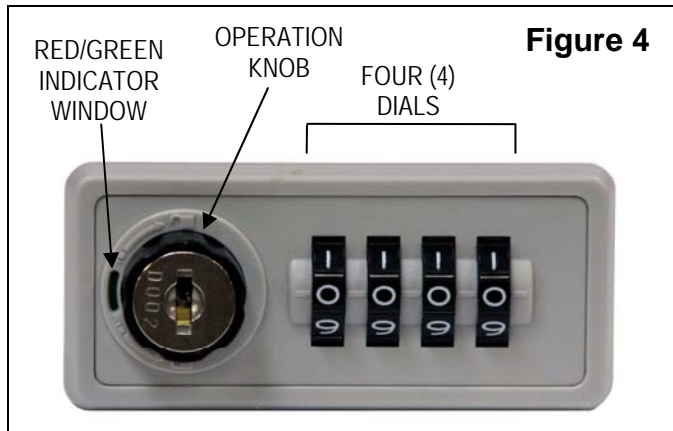

There are two (2) modes of operation: fixed combination or resettable combination. In fixed combination mode, the lock is continually opened and closed with the same custom combination that was set. In the resettable combination mode, the combination may be changed after each time the lock is opened.

The factory preset combination is 0000. Master key operation may be used at any time to open a lock.

Setup for a Fixed Combination

1. If locked, turn the four (4) dials to the factory preset combination (0000) or the known combination that unlocks the lock.
2. Turn the operation knob clockwise 180° to the open position. The indicator in the window will turn from red to green.
3. Turn the reset/fix stem on the back of the lock from the "Fix" to the "Reset" position. See Figure 5.
4. Returning to the front of the lock, set the desired custom fixed combination on the four (4) dials.
5. On the back of the lock, return the reset/fix button back to "Fix".

The lock is now set to continuously open using the desired custom fixed combination. After locking, scrambling the four (4) dials will secure the contents.

Setup for a Resettable Combination

1. If locked, turn the four (4) dials to the factory preset combination (0000) or the known combination that unlocks the lock.
2. Turn the operation knob clockwise 180° to the open position. The indicator in the window will turn from red to green.
3. Turn the reset/fix stem on the back of the lock from the "Fix" to the "Reset" position. Leave the button in this position. See Figure 5.
4. Close the door. Do not lock it.

The lock combination can now be resettable by the user setting their own desired combination before turning the operation knob to the locked position (red window indicator). After locking, scrambling the four (4) dials will secure the contents.

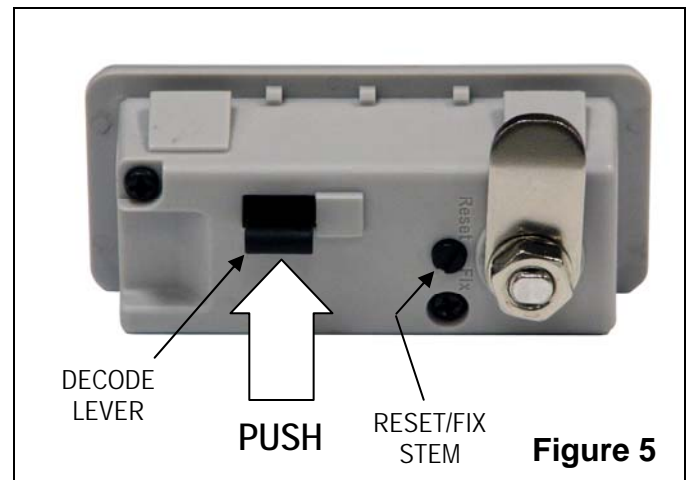

Decode Operation

Used to determine lock combination.

1. Open the door. Use the master key if necessary.
2. Push the decode lever up and while holding it, rotate each of the dials on the front of the lock until it stops or there is a "click" sound. Release the decode lever.
4. Each dial will now be in the "open" combination position.

SALSBU^RY INDUSTRIES

1010 East 62nd Street, Los Angeles, CA 90001-1598
Phone: 1-800-624-5269 Int'l Phone: 323-846-6700
Fax: 1-800-624-5299 Int'l Fax: 323-846-6800

www.lockers.com

www.mailboxes.com

engineering@mailboxes.com

engineering@lockers.com